

REVISIONS					
P	LTR	DESCRIPTION	DATE	DWN	APVD
E5	REVISD	ECR-19-009995	04OCT2019	DM	HK
E6	REVISD PER	ECR-22-154022	24NOV2022	RK	MT

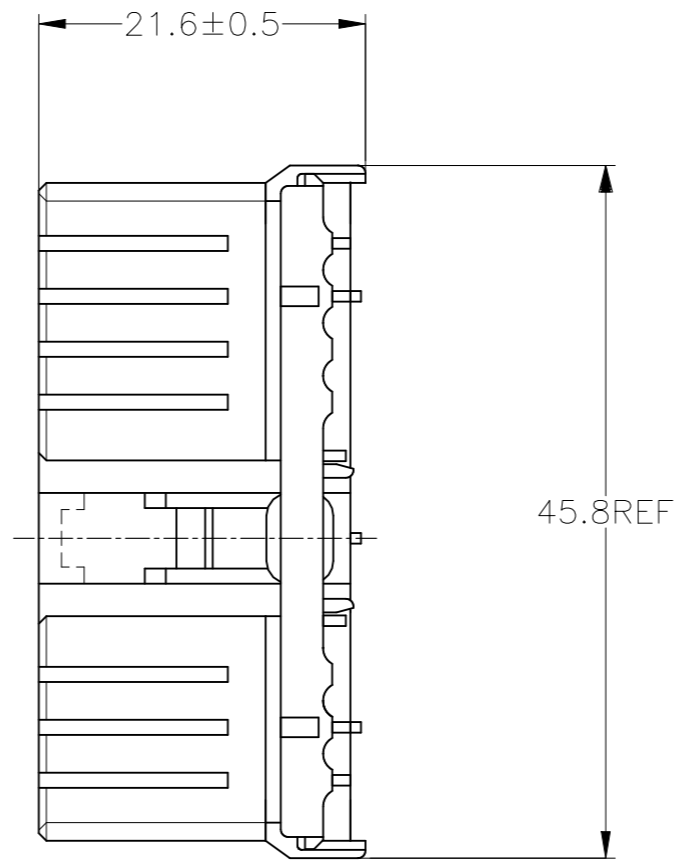

- MUST BE KEPT BETWEEN -A- AND 2
- TO BE MATED WITH PLUG HOUSING SMOOTHLY
- APPLIED TAB CONTACT; P/N 173630 AND 173631
- APPLIED CAP HOUSING; P/N 174936 etc

- A- 面より2mmの範囲で測定
- 相手ハウジングと所定の機能を満足して嵌合できること
- 内装するタブコンタクトは型番173630、173631
- 嵌合相手ハウジング型番174936 他

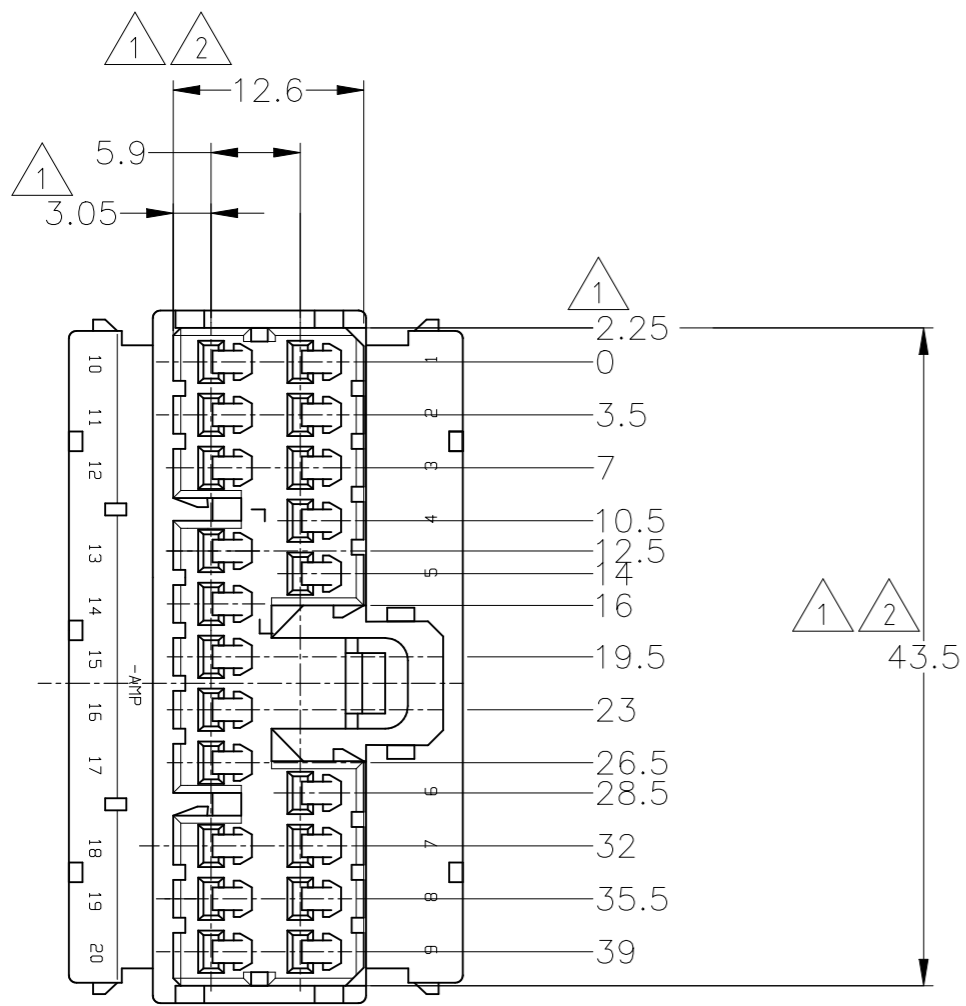
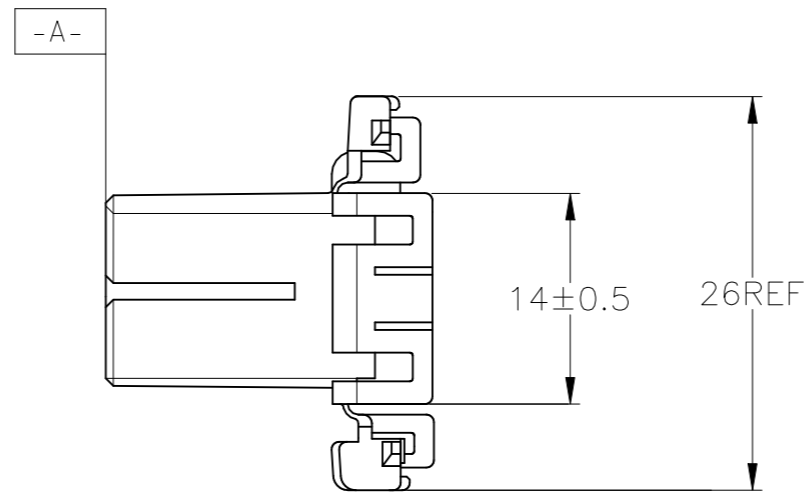

OBSELETE

V-2	自然色 (NATURAL)	1-174952-1
	黄 (YELLOW)	174952-7
	灰 (GRAY)	174952-6
	青 (BLUE)	174952-5
HB	緑 (GREEN)	174952-4
	黒 (BLACK)	174952-2
	自然色 (NATURAL)	174952-1
使用材料難燃グレード (FLAMMABILITY OF MATERIAL)		色 (COLOR)
		型番 (PART NUMBER)

TOLERANCES UNLESS OTHERWISE SPECIFIED:  
一般公差

10 <sub>±</sub>	: ±0.2
30 <sub>±</sub>	> 10 : ±0.25
	> 30 : ±0.3
ANGLE	: 3°

THIS DRAWING IS A CONTROLLED DOCUMENT.

DIMENSIONS:	TOLERANCES UNLESS OTHERWISE SPECIFIED:
mm	
	0 PLC ± -
	1 PLC ± -
	2 PLC ± -
	3 PLC ± -
	4 PLC ± -
	ANGLES ± -
	FINISH -

MATERIAL	PBT
----------	-----

DWN	S.FUJITA	09DEC08
CHK	K.BETSUI	09DEC08
APVD	K.BETSUI	09DEC08
PRODUCT SPEC	-	
APPLICATION SPEC	-	
WEIGHT	7.8 g	

**STE** TE Connectivity

070 SERIES MULTILOCK CONNECTOR  
20POSITION PULG HOUSING

SIZE	A3	CAGE CODE	00779	DRAWING NO	C-174952	RESTRICTED TO	-
CUSTOMER DRAWING			SCALE	2:1	SHEET	1 OF 1	REV E6