

4

3

2

1

THIS DRAWING IS UNPUBLISHED.

RELEASED FOR PUBLICATION

ALL RIGHTS RESERVED.

© COPYRIGHT - By -

LOC	DIST	REVISIONS						
		P	LTR	DESCRIPTION	DATE	DWN	APVD	
J	-		C5	REVISED	ECR-14-013120	05SEP2014	TS	RK

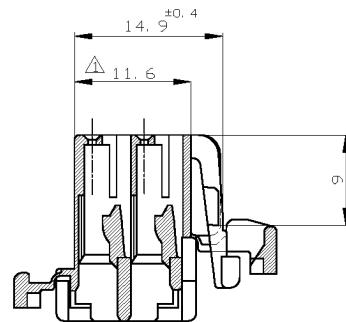
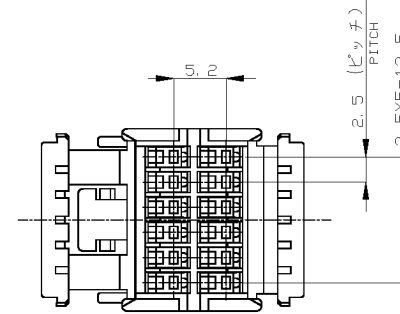
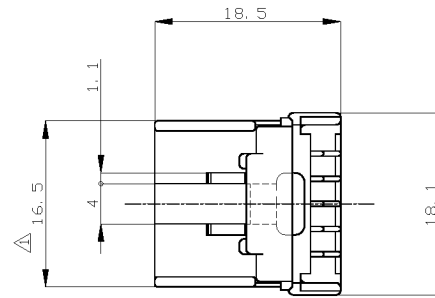
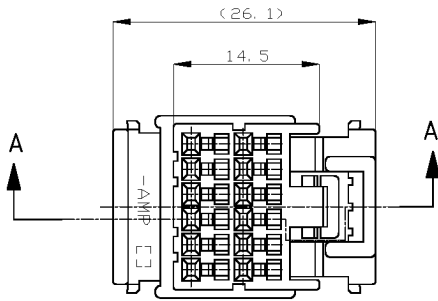

A-A

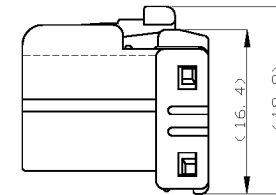
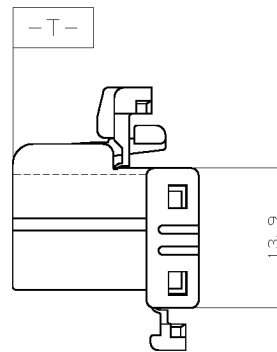
二重ロック時
DOUBLE LOCKED

△ TO BE MEASURED WITHIN 2mm FROM [-T-]

- THE MATING CAP HOUSING NUMBERS: 174973, 174051, 174058, 174979, 174149 AND 174151
- APPLIED CONTACT PART NUMBER: 173681, 175180

△ [-T-] 面より2mmの範囲で測定

- 嵌合相手ハウジング型番: 174973, 174051, 174058, 174979, 174149 AND 174151
- 内装するコンタクト型番: 173681, 175180

TOLERANCE UNLESS OTHERWISE SPECIFIED: 一般公差
0 < x ≤ 10 : ±0.2
10 < x ≤ 30 : ±0.25
30 < x ≤ 100 : ±0.3
ANGLE : ±3°

THIS DRAWING IS A CONTROLLED DOCUMENT.

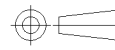
DIMENSIONS:
単位: 概
mmMATERIAL
材料
PBTTOLERANCES UNLESS OTHERWISE SPECIFIED:
一般公差

0 PLC	±
1 PLC	±
2 PLC	±
3 PLC	±
4 PLC	±
ANGLES	±
FINISH 仕上	-

DWN 03AUG06
M.SUGAWARACHK 03AUG06
K.BETSUIAPVD 03AUG06
K.BETSUIPRODUCT SPEC
製品規格
108-5352,5244APPLICATION SPEC
取付適用規格

WEIGHT 2.8 g

CUSTOMER DRAWING

FJPI-174045-5	青 (BLUE)	174045-5
FJPI-174045-4	緑 (GREEN)	174045-4
FJPI-174045-2	黒 (BLACK)	174045-2
FJPI-174045-1	黒 (BLACK)	174045-1
PACKING INSTRUCTION NUMBER (梱包仕様書番号)	色 (COLOR)	製品型番 (PART NUMBER)

12POSITION PLUG HOUSING
040SERIES MULTI-LOCK CONNECTOR

SIZE	CAGE CODE	DRAWING NO 番号	RESTRICTED TO
A3	00779	174045	-

SCALE
尺度 2:1

SHEET 1 OF 1

REV C5