

THIS DRAWING IS UNPUBLISHED. RELEASED FOR PUBLICATION 2018
 © COPYRIGHT 2018 BY TE ALL RIGHTS RESERVED.

REVISIONS					
P	LTR	DESCRIPTION	DATE	DWN	APVD
C		RELEASED PER E.O. P20392	03DEC2009		RDR
D		REVISED PER PCN :E-18-007949	23MAY2018	DD	DM
D1		REVISED PER PCN-25-234384	31JAN2025	RK	CB

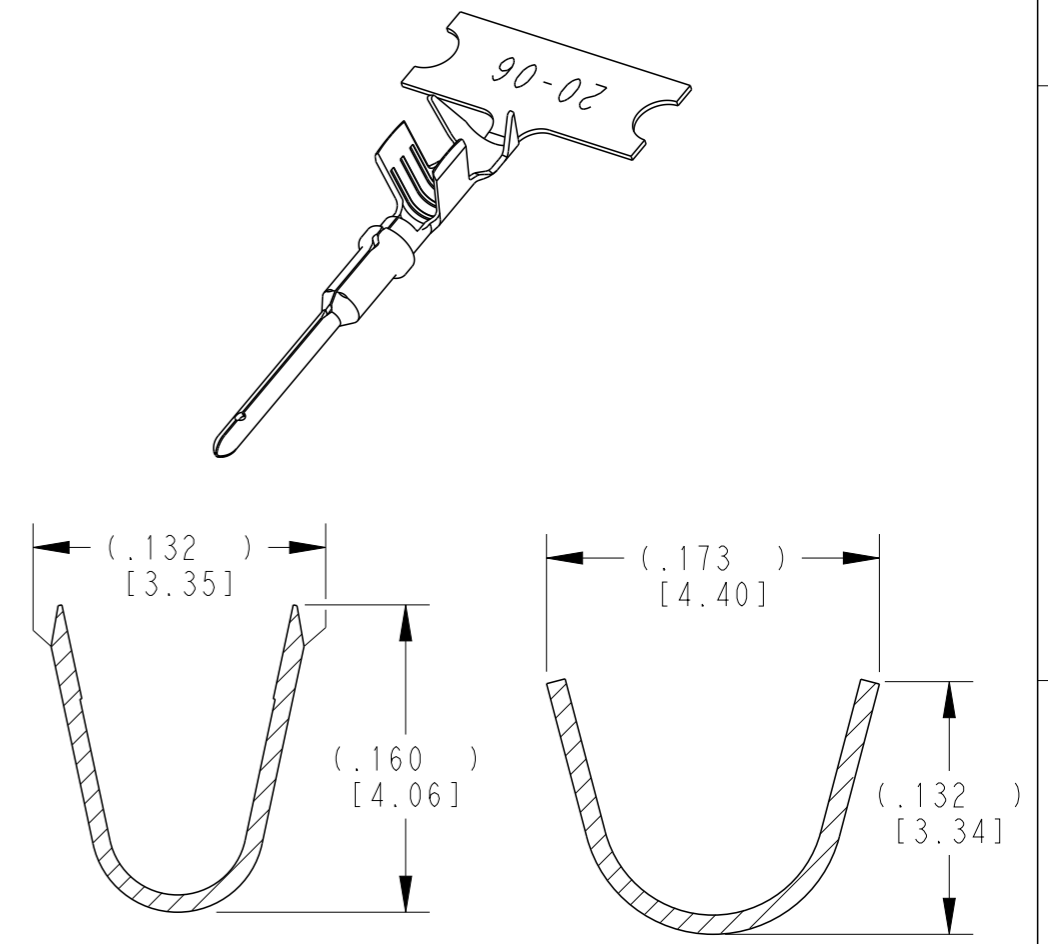
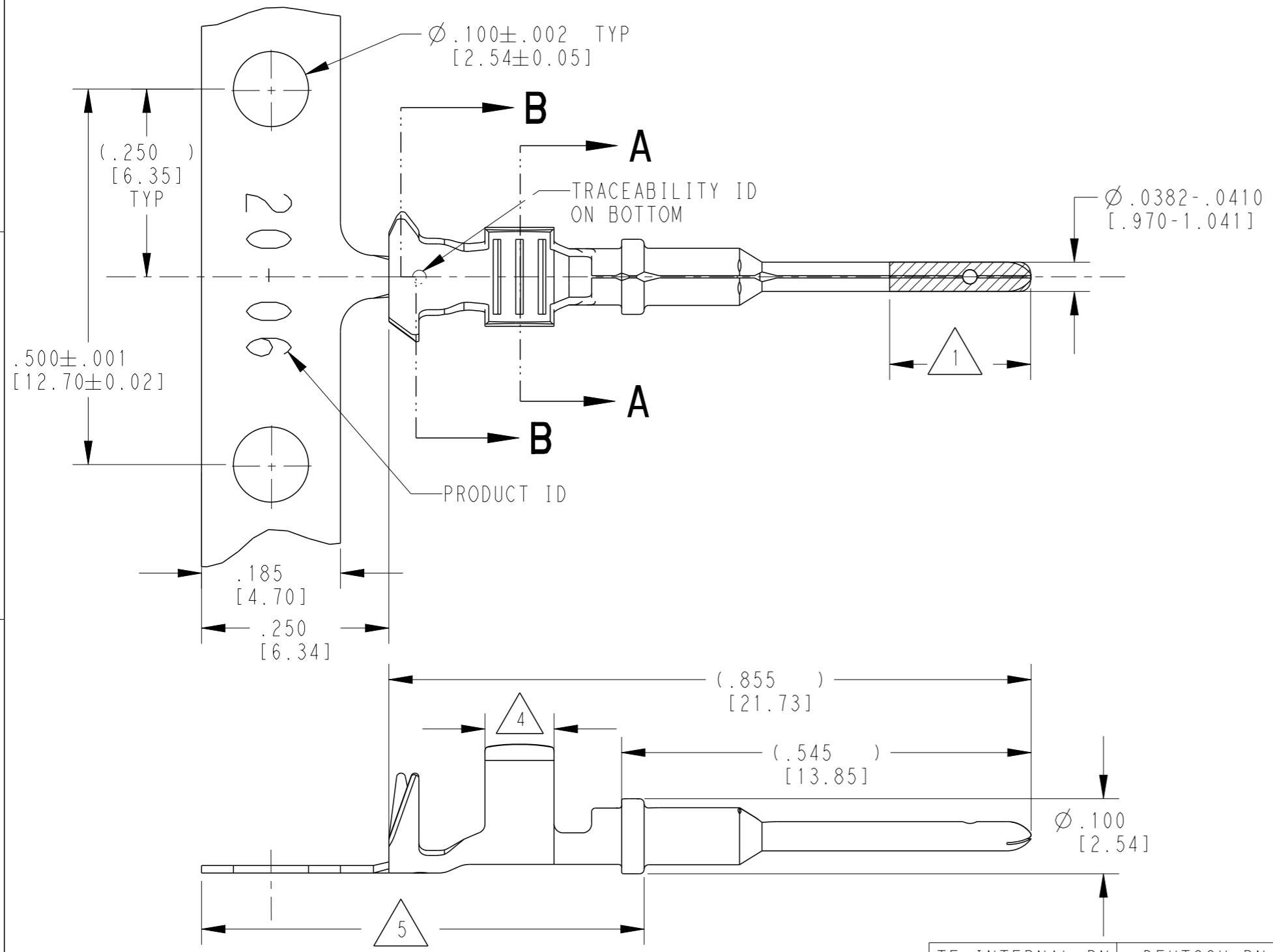

- 5 TIN PLATING MAY BE IN THIS REGION.
- 4 TIN PLATED REGION.
- 3 MATERIAL: .010 [0.25] THICK COPPER ALLOY
- 2. WIRE RANGE: 16 AWG TO 14 AWG [1.0-2.5 mm²]
INSULATION RANGE: Ø.075-.125 [Ø1.91-3.18]
- 1 GOLD PLATED REGION.

NOTES: UNLESS OTHERWISE SPECIFIED

TE INTERNAL PN	DEUTSCH PN	REV	PLATING
1060-20-0622	1060-20-0622	E	Ni/Cu Overall
1060-20-0644	1060-20-0644	E	Selective Au, Ni/Cu Overall, Sn/Ni/Cu Wire Barrel
1060-20-0677	1060-20-0677	E	Sn/Ni/Cu Overall

THIS DRAWING IS A CONTROLLED DOCUMENT.		DWN J. APOSTOL 24MAY2007	STE TE Connectivity		
DIMENSIONS: INCHES [mm]		CHK D. MEYER 02DEC2009			
TOLERANCES UNLESS OTHERWISE SPECIFIED:		APVD R. REED 02DEC2009	NAME PIN, STAMPED CONTACT SIZE 20 14-16 AWG, .075-.125 INS		
0 PLC ± 1 PLC ± 2 PLC ± 3 PLC ±.025 [0.64] 4 PLC ± ANGLES ±		PRODUCT SPEC 0425-015-0000	SIZE A3	CAGE CODE 4AFU8	DRAWING NO C=1060-20-06XX
MATERIAL 3		APPLICATION SPEC 114-151003	RESTRICTED TO -	SCALE 6:1	
FINISH SEE TABLE		WEIGHT 0.17 g	SHEET 1 OF 1		REV D1
CUSTOMER DRAWING			REVISED PER PCN-25-234384		