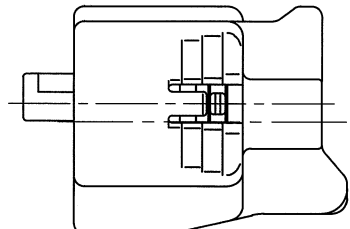

TABLE 1

SUB ASSEMBLY PART NO. AND CH. CODE	NO.	PART NO. AND CH. CODE	MATERIAL	COLOR	QTY.
7283-1056-30 ETC.	①	SEE TABLE 2	PBT	SEE TABLE 2	1
	②	7157-4364	PBT	NATURAL	1
	③	△7137-2241-60	△SILICONE RUBBER	△LIGHT GREEN	1

△TABLE 2

SUB ASSEMBLY PART NO. AND CH. CODE	PART NO. AND CH. CODE	COLOR
7283-1056, □	7183-1056	NATURAL
7283-1056-10, □	7183-1056-10	DARK GRAY
7283-1056-30, □	7183-1056-30	BLACK
△7283-1056-40, □	7183-1056-40	LIGHT GRAY



注記

- △ 1. 適用端子番 : 7116-4025 ETC.
- △ 2. 嵌合相手番 : 99159-10534 ETC. (機器直付)

NOTES

- △ 1. APPLICABLE TERMINAL NO. : 7116-4025 ETC.
- △ 2. MATING PART NO. : 99159-10534 ETC. (DIRECT CONNECTOR)

△	01.05.10	ADDED PART NO.	C01-X471	C. T
△	99.07.09	ELIMINATED COLOR NO., CHANGED FORM, MATERIAL, PART NO. & COLOR. □	C99-M110	C. T
△	99.05.11	DECREASED NOTES	C99-L587	M. F
△	97.05.08	CHANGED FORM, □	C97-L769	H. K
△	96.05.27	ADDED HOUSING COLOR	C96-L998	M. T
	90.11.26	NEW	C90-M277	H. A
LET	DATE	REVISION RECORD	NO.	CHKD

GENERAL TOLERANCE										VENDOR NO.			MATERIAL SPEC.		TREAT. & FIN.	
	10MAX	50MAX	100MAX	250MAX	250OVR	ANGLE	ECCENT	DWG TYPE	DWG SOURCE	DWG DATE	UNIT	SCL	ANGLE	PART NO. CH. CODE	NAME	
A	±0.15	±0.2	±0.3	±0.5	±0.75	±30'	0.1	R	NEW	90.11.26	mm	2/1	3	△7283-1056-30 ETC.	2・3Ⅱ(090Ⅱ) 5P SEALED CONNECTOR	
B	±0.2	±0.3	±0.55	±0.95	±1.4	±30'	0.1	APPROVED	CHECKED	CHECKED	DESIGN	DRAWN	7283-1056-30:R	HOUSING FEMALE (TYPE C) SUB ASSEMBLY		
◎	±0.3	±0.5	±0.8	±1.4	±2	±30'	0.15				TAKEUCHI	OHKUBO		SET DWG NO.		
SPECIFIED							MASS	g	加藤	山梨	鳥居	TAKEUCHI	OHKUBO	YAZAKI CORPORATION		
									01.05.17	01.05.16	01.05.14	90.04.18	01.05.10			

1

2

3

