

1

2

3

YAZAKI SUB ASS'Y NO.	NO.	YAZAKI PART NO.	YAZAKI PART NAME	MATERIAL	COLOR
7282-8120-10 ETC	①	SEE TABLE	090 II 2P SEALED CONNECTOR HOUSING MALE	PBT	SEE TABLE
	②	7157-4357	090 II 2P SEALED CONNECTOR SPACER MALE	PBT	NATURAL

YAZAKI SUB ASS'Y NO.	YAZAKI PART NO.	COLOR
7282-8120	7182-8120	NATURAL
7282-8120-10	7182-8120-10	DARK GRAY
7282-8120-30	7182-8120-30	BLACK
7282-8120-40	7182-8120-40	LIGHT GRAY

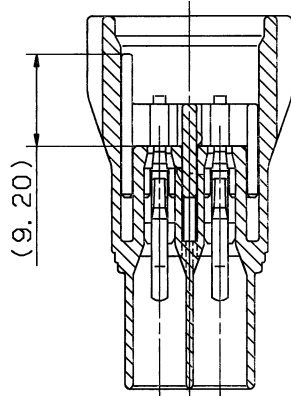
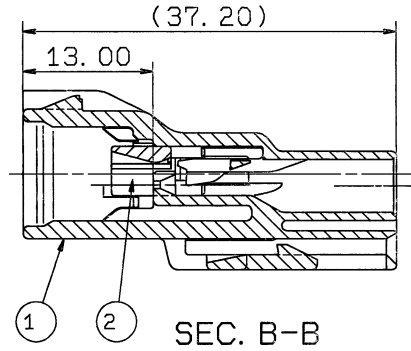
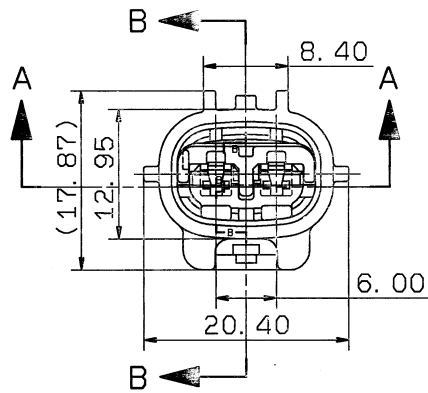

SEC. A-A

SEC. B-B

注記

- 嵌合相手品番 : 7283-7526 ETC.
- 適用端子品番 : 090 II 7114-4025 ETC.
- 適用ゴム検品番 : 7157-3648

NOTES

- MATING PART NO. : 7283-7526 ETC.
- APPLICABLE TERMINAL NO. : 090 II 7114-4025 ETC.
- APPLICABLE SEAL RUBBER NO. : 7157-3648

ISSUE MARK

				CUSTOMER				MATERIAL SPEC.				TREAT. & FIN.			
				CUSTOMER PART NO.				CUSTOMER DWG NO.				NAME			
91.11.15				NEW				C91-L839				M. Y			
LET				DATE				REVISION RECORD				NO.			
								OFFICE				TRIAL PART NO.			
								VENDOR							
								VENDOR NO.							
GENERAL TOLERANCE								PART NO.							
								7282-8120-10 ETC.							
10MAX								DWG NO.							
50MAX								7282-8120:R							
100MAX								APPROVED							
250MAX								CHECKED							
2500VR								CHECKED							
ANGLE								DESIGN							
ECCENT								DRAWN							
A ±0.15								MIWA							
B ±0.2								ISHIZUKA							
C ±0.3								91.11.18							
SPECIFIED								91.11.18							
MASS								91.11.18							
								89.09.07							
								91.11.15							

1

2

3

