

SEC. A-A

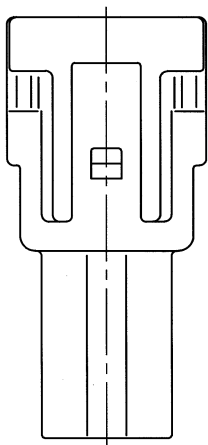
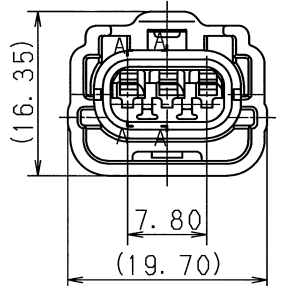

SUB ASSEMBLY PART NO. AND CH. CODE	NO.	PART NO. AND CH. CODE	MATERIAL	COLOR	QTY.
7282-7771-80 (7C82-7771-80)	①	7182-7771-80 △(7B82-7771-80)	PBT	DARK BROWN	1
	②	7137-2538-80 △(7B37-2538-80)	SILICONE RUBBER	BROWN	1
7282-7771-10	①	7182-7771-10	PBT	DARK GRAY	1
	②	7137-2538-80	SILICONE RUBBER	BROWN	1

注記

- △△ 1. 嵌合相手品番 : 7183-7771-80 (7B83-7771-80), 7183-7771-10
- △△ 2. 適用端子品番 : 7114-1466-02 (7B14-1466-02) ETC.
- △△ 3. 適用フロントホルダ品番 : 7158-4882 (7B58-4882)
- △△ 4. 適用ゴム栓品番 : 7158-3120-90 (7B58-3120-90) ETC.
- △△ 5. 適用防水栓品番 : 7157-3992-90 (7B57-3992-90)
- △△ 6. () 内品番は、エアバッグ (A/B) 回路及び、特別管理回路に使用するとき、適用すること。

NOTES

- △△ 1. MATING PART NO. : 7183-7771-80 (7B83-7771-80), 7183-7771-10
- △△ 2. APPLICABLE TERMINAL NO. : 7114-1466-02 (7B14-1466-02) ETC.
- △△ 3. APPLICABLE FRONT HOLDER NO. : 7158-4882 (7B58-4882)
- △△ 4. APPLICABLE SEAL RUBBER NO. : 7158-3120-90 (7B58-3120-90) ETC.
- △△ 5. APPLICABLE RUBBER STOPPER NO. : 7157-3992-90 (7B57-3992-90)
- △△ 6. () PART NO. IS USED FOR PARTS ASSOCIATED WITH A/B CIRCUITS OR OTHER SPECIFIED CIRCUIT.

ISSUE MARK

△	03.10.06	ADDED A/B PART NO. & ADDED NOTE	C03-X619	T. H	CUSTOMER				MATL. SPEC. SEE TABLE			TREAT. & FIN.			
△	02.01.28	ADDED COLOR NO. & CHANGED NOTE	C02-X108	O. S	CUSTOMER PART NO.		CUSTOMER DWG NO.								
	98.04.02	NEW	C98-L593	M. I	OFFICE		TRIAL PART NO.			NAME RK-TYPE CONNECTOR					
LET	DATE	REVISION RECORD	NO.	CHKD	VENDOR		VENDOR NO.			△ 3PM (BR, DGY) SUB ASSEMBLY					
GENERAL TOLERANCE					PART NO. CH. CODE										
	10MAX	50MAX	100MAX	250MAX	250OVR	ANGLE	ECCENT	DWG TYPE	DWG SOURCE	DWG DATE	UNIT	SCL	ANGLE	△ 7282-7771-80 △ (7C82-7771-80) ETC.	
A	±0.15	±0.2	±0.3	±0.5	±0.75	±30'	0.1	R	NEW	98.04.02	mm	2/1	3		
B	±0.2	±0.3	±0.55	±0.95	±1.4	±30'	0.1	APPROVED	CHECKED	CHECKED	DESIGN	DRAWN		DWG NO. 7282-7771-80 : R	
©	±0.3	±0.5	±0.8	±1.4	±2	±30'	0.15	M. TSUJI		Y. OHKUBO		SET DWG NO.			
SPECIFIED				MASS		9		47 2 10		大住		濱井		YAZAKI CORPORATION	
								03.11.05		103.10.31		03.10.31		97.06.20 03.10.06	

1

2

3