

SEC. B-B

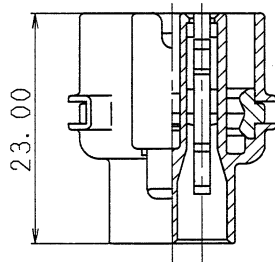

SEC. A-A

TABLE 1		3			
SUB ASSEMBLY PART NO. AND CH. CODE	NO.	PART NO. AND CH. CODE	MATERIAL	COLOR	QTY.
7223-9327 ETC.	①	SEE TABLE 2	PBT	SEE TABLE 2	1
	②	7137-1375	NBR	BLUE	1

TABLE 2		3	
SUB ASSEMBLY PART NO. AND CH. CODE	PART NO. AND CH. CODE	COLOR	
7223-9327	7123-9327	NATURAL	
△ 7223-9327-10	7123-9327-10	DARK GRAY	
7223-9327-30	7123-9327-30	BLACK	
△ 7223-9327-40	7123-9327-40	LIGHT GRAY	
7223-9327-90	7123-9327-90	BLUE	

注記

1. 通用端子品番 : 7116-1420 ETC.

2. 通用ゴム品番 : 7157-3648 ETC.

△ 3. 嵌合相手品番 : 7122-9327

NOTES

1. APPLICABLE TERMINAL NO. : 7116-1420 ETC.

2. APPLICABLE RUBBER NO. : 7157-3648 ETC.

△ 3. MATING PART NO. : 7122-9327

△ 01.06.15	ADDED NOTES & CHANGED NAME	C01-X576	C. T	CUSTOMER		MATL. SPEC.	SEE TABLE 1	TREAT. & FIN.	ISSUE MARK
△ 90.02.16	ADDED PART NO.	C90-6181	K. S	CUSTOMER PART NO.		CUSTOMER DWG NO.		NAME △ 2.3 (090) 2P SEALED CONNECTOR	
△ 90.02.03	ADDED PART NO.	C90-L084	H. Y	OFFICE		TRIAL PART NO.		SUB ASSEMBLY FEMALE (WASHER)	
88.07.12	NEW	8MC-3020	S. Y	VENDOR		VENDOR NO.		PART NO. 7223-9327 ETC.	
LET	DATE	REVISION RECORD	NO.	CHKD	VENDOR		VENDOR NO.		PART NO. CH. CODE 7223-9327:R
GENERAL TOLERANCE				DWG TYPE	DWG SOURCE	DWG DATE	UNIT	SCL	ANGLE
A	±0.15	±0.2	±0.3	±0.5	±0.75	±30'	0.1	R	NEW
B	±0.2	±0.3	±0.55	±0.95	±1.4	±30'	0.1	APPROVED	CHECKED
◎	±0.3	±0.5	±0.8	±1.4	±2	±30'	0.15	DESIGN	DRAWN
SPECIFIED				MASS	g		01.06.26		01.06.25
				加藤		山梨		鳥居	
				01.06.26		01.06.25		01.06.20	
				84.02.18		01.06.15		YAZAKI CORPORATION	

