

A

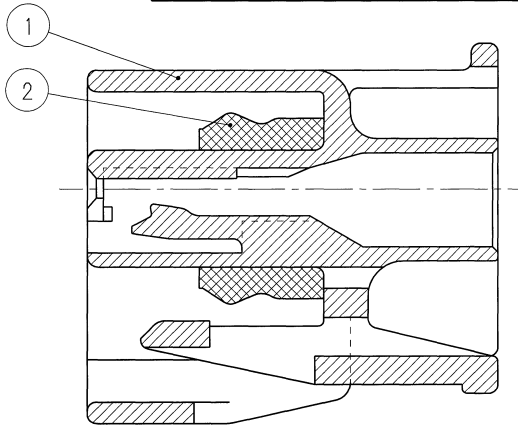

SEC. B-B

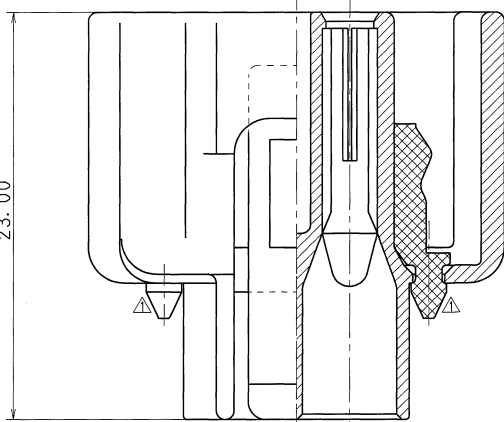

SEC. A-A

TABLE 1

SUB ASSEMBLY PART NO. AND CH. CODE	NO.	PART NO. AND CH. CODE	PART NAME	MATERIAL	COLOR	QTY.
7223-1324 ETC.	①	SEE TABLE 2	2.3 2P SEALED HOUSING FEMALE (O. V. C. V)	PBT	SEE TABLE 2	1
	②	7137-1470	2.3 SEALED PACKING (O. V. C. V)	NBR	BLUE	1

TABLE 2

SUB ASSEMBLY PART NO. AND CH. CODE	PART NO. AND CH. CODE	COLOR
7223-1324. A	7123-1324	NATURAL
7223-1324-10. A	7123-1324-10	DARK GRAY
7223-1324-30. A	7123-1324-30	BLACK
7223-1324-40. A	7123-1324-40	LIGHT GRAY
7223-1324-50. A	7123-1324-50	ORANGE
7223-1324-60. A	7123-1324-60	GREEN
7283-1324-60. A	7183-1324-60. A	DARK GREEN
7223-1324-80. A	7123-1324-80	BROWN
7223-1324-90. A	7123-1324-90	BLUE

NOTES

- MATING RUBBER STOPPER NO. :7157-3648
- MATING TERMINAL NO. :7116-1420, 7116-1421

注記

- 通気ゴム栓 NO. :7157-3648
- 通気端子 NO. :7116-1420, 7116-1421

DATE	REVISION RECORD	NO.	CHKD
12.03.20	ADDED PART NO., ETC.	C12-Z320	R. M
89.07.03	CORRECTED AN ERROR IN WRITING	C89-7050	M. H
89.03.14	ADDED PART NO.	C89-6405	H. Y
88.12.15	CORRECTED AN ERROR IN WRITING	8MC-1277	H. Y
88.11.11	ADDED PART NO.	8MC-1509	H. Y
88.06.27	ADDED PART NO.	8MC-0698	K. M
88.04.21	ADDED PART NO.	8MC-0450	M. S
87.10.26	CHANGED FORM & RENEW	7MC-0635	I. O
85.04.15	NEW	C85-5364	M. T

GENERAL TOLERANCE

	10MAX	50MAX	100MAX	250MAX	2500VR	ANGLE	ECCENT
A	±0.15	±0.2	±0.3	±0.5	±0.75	±30'	0.1
B	±0.2	±0.3	±0.55	±0.95	±1.4	±30'	0.1
◎	±0.3	±0.5	±0.8	±1.4	±2	±30'	0.15

SPECIFIED

CUSTOMER	CUSTOMER PART NO.	CUSTOMER DWG NO.	MATL. SPEC.	TREAT. & FIN.
			SEE TABLE 1	
OFFICE	TRIAL PART NO.		NAME 2.3 2P SEALED HOUSING SUB	
VENDOR	VENDOR NO.		ASSEMBLY FEMALE (O. V. C. V)	
DWG TYPE			PART NO. CH. CODE	
R	NEW	85.04.15	7223-1324 ETC.	
APPROVED	CHECKED	CHECKED	DESIGN	DRAWN
M. FUKUDA	Y. SASAKI	K. KIDA	TSUJI	R. MAJERANO
12.03.20	12.03.20	12.03.20	84.09.12	12.03.20
DWG NO.			SET DWG NO.	
7223-1324:R				
YAZAKI CORPORATION				

1

2

3

4

5