

TABLE 1

SUB ASSEMBLY PART NO. AND CH. CODE	NO.	PART NO. AND CH. CODE	PART NAME	MATERIAL	COLOR	QTY.
7222-7484-40 ETC.	①	SEE TABLE 2	SWP-TYPE HOUSING 8P M	PBT	SEE TABLE 2	1
	②	7137-1554-80	SWP-TYPE LIP PACKING 8P	SILICONE RUBBER	RED-IRON	1

TABLE 2

SUB ASSEMBLY PART NO. AND CH. CODE	PART NO. AND CH. CODE	COLOR
7222-7484-30	7122-7484-30	BLACK
7222-7484-40	7122-7484-40	GRAY

注記

- 1. かん合相手品番 : 7123-7484-40 ETC.
- 2. 適用端子品番 : 7114-1471 ETC.
- 3. 適用リアホルダ品番 : 7157-7817-80
- 4. 適用ゴム栓品番 : 7157-7897-60 ETC.
- 5. 適用空栓品番 : 7157-8767-80 ETC.

NOTES

- 1. MATING PART NO. : 7123-7484-40 ETC.
- 2. APPLICABLE TERMINAL PART NO. : 7114-1471 ETC.
- 3. APPLICABLE REAR HOLDER PART NO. : 7157-7817-80
- 4. APPLICABLE WIRE SEAL PART NO. : 7157-7897-60 ETC.
- 5. APPLICABLE PLUG PART NO. : 7157-8767-80 ETC.

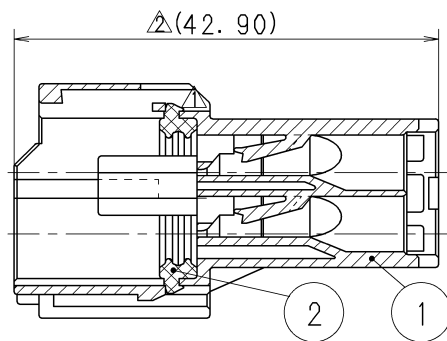
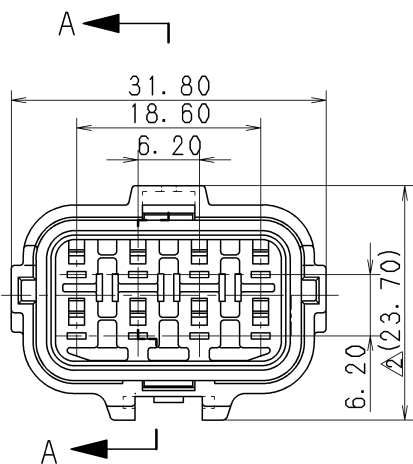

SEC. A-A

ISSUE MARK

							CUSTOMER					MATL. SPEC. △ SEE TABLE 1			TREAT. & FIN.			
							CUSTOMER PART NO.				CUSTOMER DWG NO.							
△ 11. 04. 25 CHANGED PART NAME ETC. C11-Z273 T. W															NAME △ SWP-TYPE HOUSING 8P M			
△ 93. 12. 20 CHANGED FORM & RENEW C93-L829 K. S							OFFICE				TRIAL PART NO.				SUB ASSEMBLY			
LET DATE REVISION RECORD NO. CHKD							VENDOR											
△ GENERAL TOLERANCE							VENDOR NO.								PART NO. 7222-7484-40 ETC.			
	10MAX	50MAX	100MAX	250MAX	250OVR	ANGLE	ECCENT	DWG TYPE	DWG SOURCE	DWG DATE	UNIT	SCL	ANGLE					
A	±0.15	±0.2	±0.3	±0.5	±0.75	±30'	0.1	R	RENEW	93.12.20	mm	△ 2:1	3	DWG NO. 7222-7484-30:R				
B	±0.2	±0.3	±0.55	±0.95	±1.4	±30'	0.1	APPROVED	CHECKED	CHECKED	DESIGN	DRAWN						
C	±0.3	±0.5	±0.8	±1.4	±2	±30'	0.15	H. KONDO	T. KOBAYASHI	T. WATANABE	KODAMA	J. CANDU						
SPECIFIED							MASS								YAZAKI CORPORATION			
							11. 04. 25				11. 04. 25				11. 04. 25			

1

2

3