

GENERAL TOLERANCE											
	10 MAX	50 MAX	100 MAX	250 MAX	250 OVR	R5 MAX	R10 MAX	R20 MAX	R20 OVR	ANGLE	ECCENT
A	±0.15	±0.2	±0.3	±0.5	±0.75	±0.2	±0.3	±0.5	±2.5	±3°	0.1
B	±0.2	±0.3	±0.55	±0.95	±1.4					±3°	0.1
◎	±0.3	±0.5	±0.8	±1.4	±2					±3°	0.15

PART NO. AND CH. CODE	COLOR
7187-5724	NATURAL
7187-5724-30	BLACK
7187-5724-40	LIGHT GRAY
7187-5724-90	BLUE

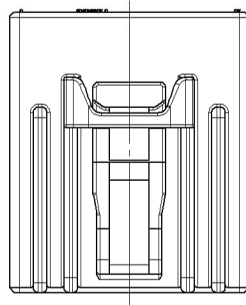

注記

1. 適用端子品番 : 7116-6040 ETC.

NOTE

1. APPLICABLE TERMINAL PART NO. : 7116-6040 ETC.

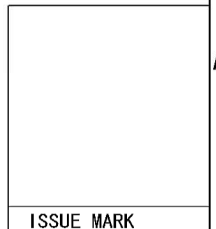
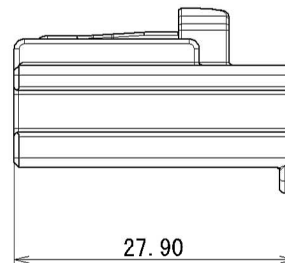
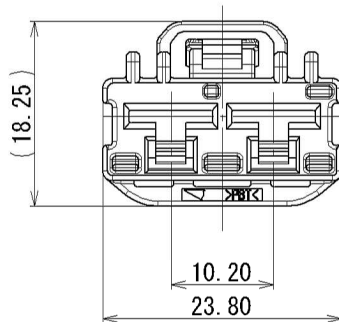

LET	DATE	REVISION RECORD	NO.	CHKD	CUSTOMER	CUSTOMER PART NO.	CUSTOMER DWG NO.	MATL. SPEC.	TREAT. & FIN.	NAME	PART NO. CH. CODE	SET DWG NO.	
△	2010/10/15	CHANGED PART NAME	C10-ZA56	M. M	CUSTOMER			PBT (SEE TABLE)		△ HLC 8.0 2P HOUSING FEMALE	7187-5724 ETC.		
	2010/02/01	NEW	C10-Z058	T. O	OFFICE		TRIAL PART NO.				7187-5724:R		
GENERAL TOLERANCE					VENDOR NO.								
A	±0.15	±0.2	±0.3	±0.5	±0.75	±30'	0.1	DWG TYPE	DWG SOURCE	DWG DATE	UNIT	SCL	ANGLE
B	±0.2	±0.3	±0.55	±0.95	±1.4	±30'	0.1	R	NEW	2010/02/01	mm	2:1	3
C	±0.3	±0.5	±0.8	±1.4	±2	±30'	0.15	APPROVED	CHECKED	CHECKED	DESIGN	DRAWN	
SPECIFIED					MASS	S. MIZUSE		R. DE GUZMAN	T. OSADA	M. MALABANAN	YAZAKI CORPORATION		
						2010/10/15		2010/10/15	2008/01/18	2010/10/15			