

1

2

3

RUBBER PART GENERAL TOLERANCE			
PART DIM.	1	2	(3)
0 TO 3	± 0.2	± 0.3	± 0.4
3 TO 6	± 0.2	± 0.4	± 0.5
6 TO 10	± 0.3	± 0.5	± 0.6
10 TO 18	± 0.3	± 0.6	± 0.8
18 TO 30	± 0.4	± 0.8	± 1.0
30 TO 50	± 0.5	± 1.0	± 1.5
50 TO 80	± 0.6	± 1.2	± 2.0
80 TO 120	± 0.7	± 1.4	± 2.5
120 TO 180	± 0.8	± 1.6	± 3.0
180 TO 250	± 1.0	± 2.0	± 4.0
250 TO 315	± 1.2	± 2.5	± 5.0
315 TO 400	± 1.5	± 3.0	± 6.0
400 TO 500	± 1.8	± 3.5	± 7.0
500 OVER	± 0.4 %	± 0.8 %	± 1.5 %

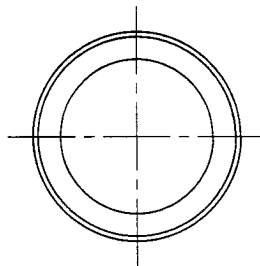
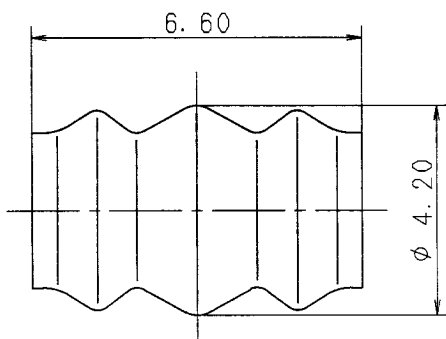

△ 注記

- ( ) 内品番は、エアバック (A/B) 回路及び特別管理回路に使用する時に適用すること。
- 適用コネクタ品番 : 7182-7779-40, 7183-7779-40 ETC.

△ NOTES

- PART NUMBERS IN PARENTHESIS SHALL BE USED FOR AIR BAG (A/B) CIRCUITS AND OTHER CIRCUITS DESIGNATED FOR SPECIAL MONITORING.
- APPLICABLE CONNECTOR NO. : 7182-7779-40, 7183-7779-40 ETC.

ISSUE MARK

△	00.03.17	ADDED PART NO. ETC., [A]	C00-L396	T. Y	CUSTOMER	CUSTOMER PART NO.	CUSTOMER DWG NO.	MATL. SILICONE RUBBER	TREAT. & FIN.						
	98.03.02	NEW	C98-6390	K. U	OFFICE	TRIAL PART NO.		SPEC. (LIGHT BLUE)							
LET	DATE	REVISION RECORD	NO.	CHKD	VENDOR	X39658-7813		NAME	RK-TYPE CONNECTOR						
GENERAL TOLERANCE					VENDOR NO.			SEALED PLUG							
	10MAX	50MAX	100MAX	250MAX	250OVR	ANGLE	ECCENT	DWG TYPE	DWG SOURCE	DWG DATE	UNIT	SCL	ANGLE	PART NO.	△7157-3992-90, [A] (7B57-3992-90)
A	±0.15	±0.2	±0.3	±0.5	±0.75	±30'	0.1	R	NEW	98.03.02	mm	10/1	3	CH. CODE	
B	±0.2	±0.3	±0.55	±0.95	±1.4	±30'	0.1	APPROVED	CHECKED	CHECKED	DESIGN	DRAWN	DWG NO.	7157-3992-90:R	SET DWG NO.
C	±0.3	±0.5	±0.8	±1.4	±2	±30'	0.15				M. TSUJI	ISHIJIMA			
SPECIFIED					MASS	g								YAZAKI CORPORATION	

1

2

3