

YAZAKI PART NO.	COLOR
7123-7721	NATURAL
7123-7721-90	BLUE
7123-7721-30	BLACK

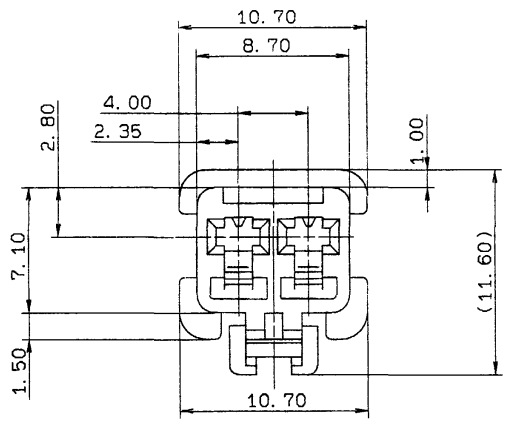

注記

- 1) 嵌合相手品番: 7122-7721
- 2) 適用端子品番: 7116-1180, 7116-1181

NOTES

- 1) MATING PART NO.: 7122-7721
- 2) APPLICABLE TERMINAL NO.: 7116-1180, 7116-1181

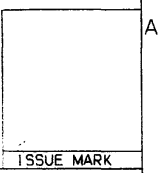
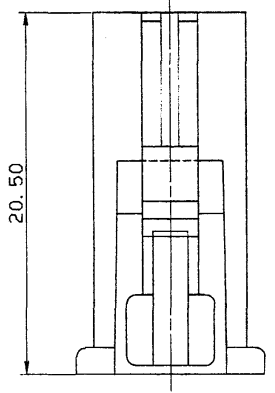
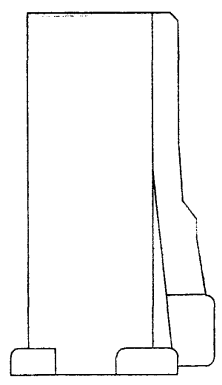

88.09.22	NEW	8MC-3130	T.M
LET	DATE	REVISION RECORD NO.	CHKD

GENERAL TOLERANCE							
	10MAX	50MAX	100MAX	250MAX	2500VR	ANGLE	ECCENT
A	±0.15	±0.2	±0.3	±0.5	±0.75	±30'	0.1
B	±0.2	±0.3	±0.55	±0.95	±1.4	±30'	0.1
◎	±0.3	±0.5	±0.8	±1.4	±2	±30'	0.15

CUSTOMER		CUSTOMER PART NO.		CUSTOMER DWG NO.		MATERIAL SPEC.		P. B. T		TREAT. & FIN.	
OFFICE		VENDOR		STDLIB NO.		NAME		090 2P-(F) HOUSING		ISSUE MARK	
DWG TYPE		DWG SOURCE		DWG DATE		UNIT		SCL		ANGLE	
R		NEW		88.09.13		mm		5/1		3	
APPROVED		CHECKED		CHECKED		DESIGN		DRAWN		PART NO.	
加藤		加藤		加藤		ASANO		S. YAGI		7123-7721 ETC.	
SPECIFIED		WEIGHT		g		88.09.27		88.09.26		88.09.23	
						85.05.23		88.09.13		DWG NO.	
										7123-7721-R	
										TRIAL PART NO.	
										YAZAKI CORPORATION	