

YAZAKI PART NO. AND CH. CODE	△(H)	MATERIAL	APPLICABLE WIRE SIZE
△3 7116-2095 (7B16-2095)	1.20	△4 BRASS t=0.32	△5 AVS 0.3 ~ 0.5
△3 7116-2095-02	1.20	BRASS t=0.32 TIN PLATING	△5 AVS 0.3 ~ 0.5
△3 7116-2640 (7B16-2640)	1.20	△4 BRASS t=0.32	△5 AVS 0.3 ~ 0.5
△3 △A 7116-2640-02, △A (7B16-2640-02, △A)	1.50	BRASS t=0.32 TIN PLATING	△5 AVS 0.3 ~ 0.5

注記

△6 1. 取扱説明書 NO. : YPES-15-011, YPES-15-099

△3 2. ()内の品番はA/B回路及び特別管理回路に使用すること。

△5 3. ※印寸法は7116-2095, 7116-2095-02の品番のみに適用し、
その他の品番のものにはランスを付けないこと。

NOTES

△6 1. HANDLING MANUAL NO. : YPES-15-011, YPES-15-099

△3 2. PART NUMBERS IN PARENTHESIS SHALL BE USED FOR AIR BAG (A/B) CIRCUITS
AND OTHER CIRCUITS DESIGNATED FOR SPECIAL MONITOR.

△5 3. * DENOTES DIMENSION APPLICABLE TO 7116-2095,
7116-2095-02 ONLY. AND OTHER PRODUCTS OF
OTHER PART NO.'S SHOULD NOT HAVE A LANGE.

△6	2016/06/30	CHANGED FORM , ETC.	C16-P280	Y. H			
△5	1996/12/10	CAD DRAW & CHANGED FORM	C96-N239	M. T			
△4	1992/02/11	誤記訂正	C92-6200	半田			
△3	1990/09/14	注記・品番追加	C90-7309	半田			
△2	1988/06/17	形状変更	8MC-0612	石神			
△1	1983/05/04	注記変更	C83-5674	福田			
	1981/08/03	NEW	C81-2644	竹之内			
LET	DATE	REVISION RECORD	NO.	CHKD			
GENERAL TOLERANCE							
	10MAX	50MAX	100MAX	250MAX	2500VR	ANGLE	ECCENT
A	±0.15	±0.2	±0.3	±0.5	±0.75	±30'	0.1
B	±0.2	±0.3	±0.55	±0.95	±1.4	±30'	0.1
C	±0.3	±0.5	±0.8	±1.4	±2	±30'	0.15
SPECIFIED							MASS
							g

CUSTOMER		MATL. SPEC.		TREAT. & FIN.	
CUSTOMER PART NO.		SEE TABLE			
OFFICE		NAME		6.3 TERMINAL FEMALE	
VENDOR		TRIAL PART NO.			
VENDOR NO.		PART NO. △5 7116-2640 (7B16-2640) ETC.			
DWG TYPE	DWG SOURCE	DWG DATE	UNIT	SCL	ANGLE
R	NEW	1981/08/03	mm	5:1	3
APPROVED	CHECKED	CHECKED	DESIGN	DRAWN	
S. SUZUKI	M. NAGANO	Y. IKEDA		Y. HANAI	
2016/06/30	2016/06/30	2016/06/30		2016/06/30	

ISSUE MARK	
PART NO. △5 7116-2640 (7B16-2640) ETC.	
DWG NO.	7116-2095:R
SET DWG NO.	
YAZAKI CORPORATION	

PART NO.	A	B	C	D	E	WIRE SIZE	REFERENCE
7116-2090	3.5	3.7	4.9	5.5	1.1	AV 0.5 ~ 2	
7116-2090-02	3.5	3.7	4.9	5.5	1.1	AV 0.5 ~ 2	Sn PLATING
7116-2092	4.5	4.7	5.9	6.5	1.4	AV 3	
7116-2092-02	4.5	4.7	5.9	6.5	1.4	AV 3	Sn PLATING

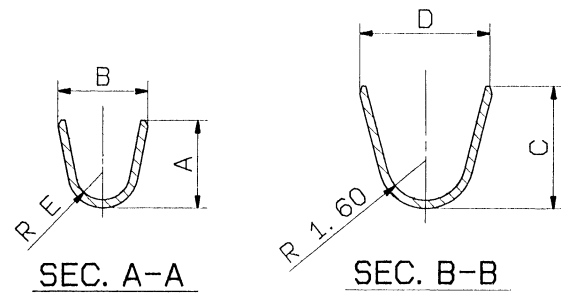
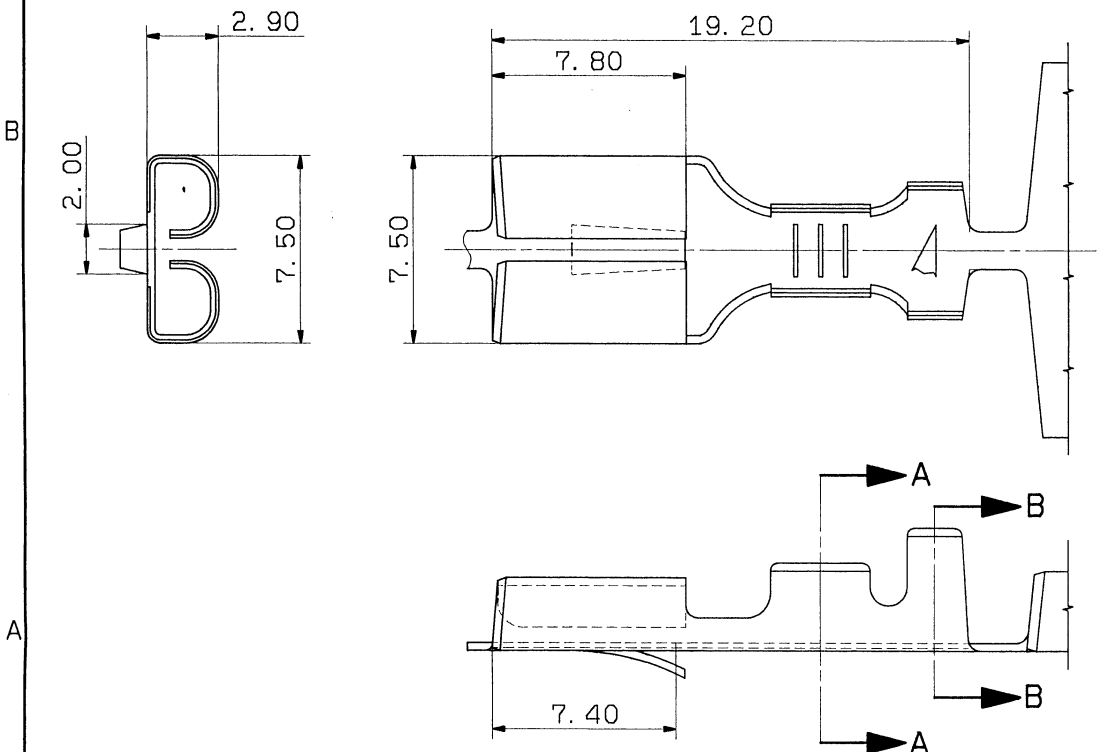

ISSUE MARK

								CUSTOMER				MATERIAL SPEC. C2600R t=0.32			TREAT. & FIN.		
								CUSTOMER PART NO.				CUSTOMER DWG NO.					
								OFFICE				NAME			250 (6.0mm) TERMINAL		
								VENDOR				TRIAL PART NO.			FEMALE		
GENERAL TOLERANCE 10MAX ±0.15 50MAX ±0.2 100MAX ±0.3 250MAX ±0.5 2500VR ±0.75 ANGLE ±30' ECCENT 0.1 B ±0.2 ±0.3 ±0.55 ±0.95 ±1.4 ±30' 0.1 © ±0.3 ±0.5 ±0.8 ±1.4 ±2 ±30' 0.15 SPECIFIED MASS								VENDOR NO.				PART NO. 7116-2090 ETC.					
								APPROVED		CHECKED		DESIGN		DRAWN		DWG NO. 7116-2090:R	
								酒井 増田		竹下		ISHIZAKI		KUZUNO		YAZAKI CORPORATION	
								94.6.6		94.6.3		94.6.1		88.08.31 94.06.01			

