

PART NO.	MATERIAL
7116-1847-02	COPPER ALLOY TIN PLATING
7116-1847-08	COPPER ALLOY GOLD PLATING

- 注記
- 嵌合雄端子番 : 7114-1847-02 ETC.
 - 適用電線サイズ : CAVS 0.3~0.5
AVSSH 0.3~0.5

- NOTES
- MATING MALE TERMINAL NO. : 7114-1847-02 ETC.
 - APPLICABLE WIRE SIZE : CAVS 0.3~0.5
AVSSH 0.3~0.5

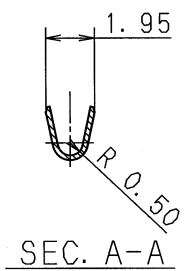
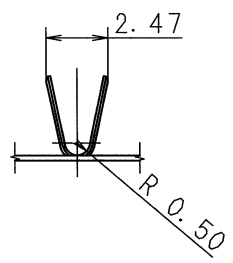
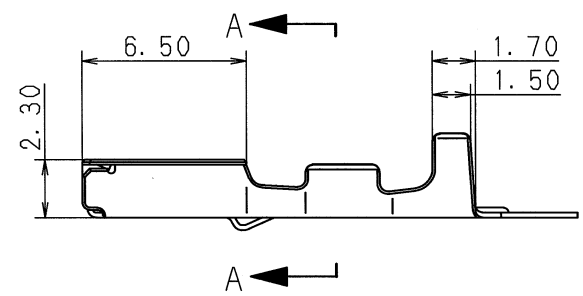
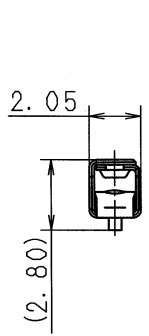
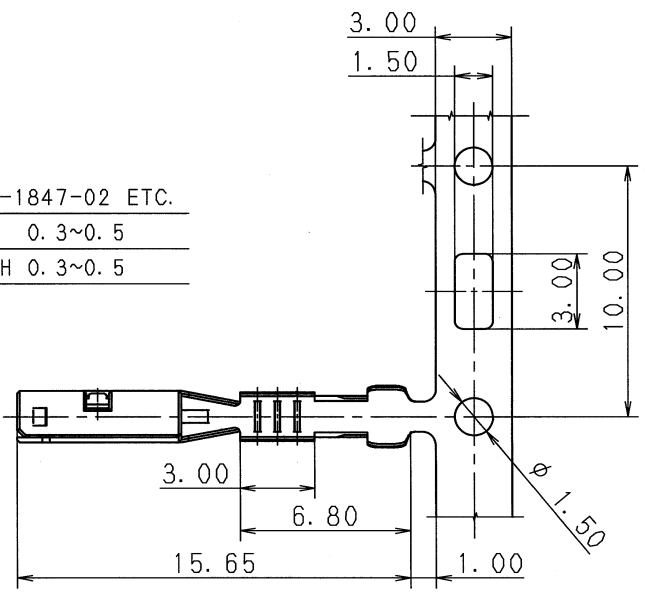

SEC. A-A

ISSUE MARK

				CUSTOMER				MATL. SEE TABLE				TREAT. & FIN.			
				CUSTOMER PART NO.				CUSTOMER DWG NO.				SPEC. (t=0.2)			
02.11.04				NEW				C02-X569				T. H			
LET				DATE				REVISION RECORD				NO. CHKD			
				OFFICE				TRIAL PART NO.				NAME RK-TYPE TERMINAL FEMALE			
				VENDOR				VENDOR NO.				(MAT SEAL)			
GENERAL TOLERANCE												PART NO. 7116-1847-02 ETC.			
												CH. CODE			
												DWG NO. 7116-1847-02:R			
												SET DWG NO.			
												YAZAKI CORPORATION			

