

注記
 1. 適用電線サイズ : CAVS 0.3~0.85. AVS 0.3~0.5
 2. かん合メス端子品番 : 7116-1680-02

NOTES
 1. APPLICABLE WIRE SIZE: CAVS 0.3~0.85. AVS 0.3~0.5
 2. MATING FEMALE TERMINAL PART NO.: 7116-1680-02

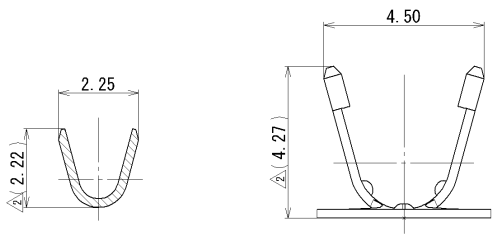
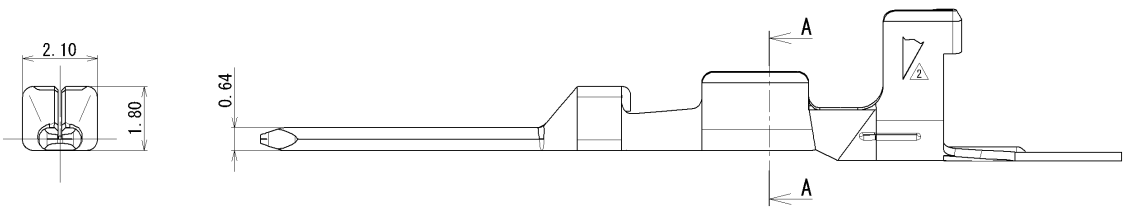

SEC. A-A

△	2010/03/25	CORRECTION OF CLERICAL ERROR ETC.	C10-Z158	T. W
△	1990/10/24	CHANGED MATERIAL	C90-7548	M. S
△	1990/09/25	NEW	C90-L993	S. I
LET	DATE	REVISION RECORD	NO.	CHKD

GENERAL TOLERANCE						
	10MAX	50MAX	100MAX	250MAX	2500VR	ECCENT
A	±0.15	±0.2	±0.3	±0.5	±0.75	0.1
B	±0.2	±0.3	±0.55	±0.95	±1.4	0.1
C	±0.3	±0.5	±0.8	±1.4	±2	0.15
SPECIFIED						MASS

CUSTOMER		MATERIAL SPEC. △ COPPER ALLOY (t=0.25)		TREAT. & FIN. TIN PLATING	
CUSTOMER PART NO.		CUSTOMER DWG NO.		NAME SSD TYPE CONNECTOR	
OFFICE		TRIAL PART NO.		TERMINAL MALE	
VENDOR		VENDOR NO.		PART NO. 7114-1680-02	
DWG TYPE R	DWG SOURCE NEW	DWG DATE 1990/09/25	UNIT mm	SCL 10:1	ANGLE 3
APPROVED H. KONDO	CHECKED K. SUZUKI	CHECKED T. WATANEBE	DESIGN ISHIZUKA	DRAWN M. MORAL	DWG NO. 7114-1680-02:R
2010/03/25	2010/03/25	2010/03/25	1989/04/06	2010/03/25	SET DWG NO.
YAZAKI CORPORATION					