

SYMBOL DEFINITION		MISSING NUMBERS		DWG STATUS		REVISION HISTORY		AUTH		DR		APV/D	
DATE	STG	REV	N/P	CHG	ZONE	DATE	REV	BY	CHK	DATE	REV	BY	CHK
12MR02	R	05	-	-	-	12/22/12		LMB	LMB	222112		LMB	CD
25FEB3	R	06	-	-	-	2/26/13		JAA	JAA	236735		JAA	MC
25JAO5	R	07	-	-	-	1/31/13		CCV	JAA	263858		CCV	MC
03MY05	R	08	-	-	-	3/26/13		RTV	JVM	267328		RTV	MJC
05OC06	R	09	-	-	-	10/15/13		MM	MM	284868		MM	MJC
05AP07	R	10	-	-	-	10/16/13		JBD	JVM	401067		JBD	PYP
23AP09	R	11	-	-	-	11/27/13		FRE	ECB	407878		FRE	VMR
05NO09	R	12	-	-	-	11/27/13		DMC	DMC	409411		DMC	DGL
12MY10	R	13	-	-	-	12/10/13		JAR	JAR	410767		JAR	VMR

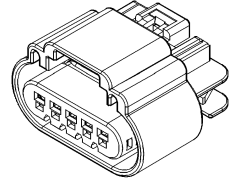

TYPE 102  
SAME AS TYPE 101  
EXCEPT AS SHOWN

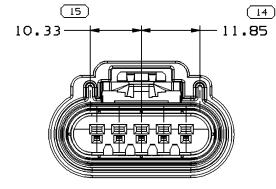
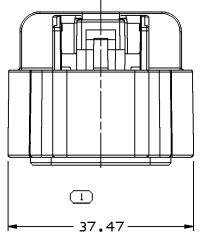
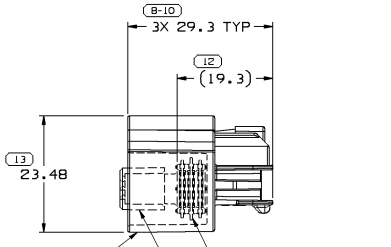
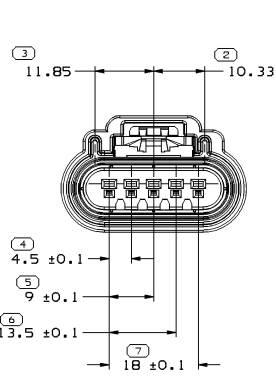

CONN - SEE CHART  
SEAL - SEE CHART  
PLR - SEE CHART

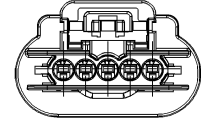

TYPE 101

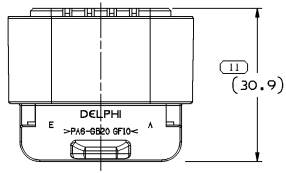

- NOTES
- UNLESS OTHERWISE SPECIFIED AND/OR INDICATED:  
DIMENSIONS ARE TO FACE OF VIEW SHOWN AND AUTOMATICALLY ROUNDED BY COMPUTER FOR INSPECTION (SEE MATH MODEL FOR PRECISE DIMENSIONS). FOR ALL OTHER DIMENSIONS NOT SHOWN BUT REQUIRED FOR TOOL BUILD, SEE MATH MODEL FOR PRECISE TOOL PATH DATA.
  - SEALING CODE 3 - DESIGN WILL PASS SALT FOG AND IMMERSION TEST AFTER CONDITIONING AS SPECIFIED IN ESA-644 (WEATHER-PACK), ESA-710 (METRI-PACK), ESA-650 (UNDERHOOD MICRO-PACK), C-4006 (WORLD CONNECTOR), ETC WHEN MATED TO MATING PART OR EQUIVALENT
  - THIS PRODUCT IS NOT CATEGORIZED AS AN APPEARANCE ITEM, MINOR IMPERFECTIONS INCLUDING, BUT NOT LIMITED TO, FLOW MARKS, COLOR BLEMISHES, GATE VESTIGE, AND SOFT FLASH THAT DO NOT AFFECT THE FIT, FORM, OR FUNCTION OF THE PART ARE PERMISSIBLE PER DPNP-4.7-CS-01.
  - THIS CONNECTOR MEETS OR EXCEEDS SAE/USCAR-2 AUGUST 1997, SECTION 5.3.1.2. TERMINAL DISENGAGE CRITERIA WITH THE APPLICATION OF A TERMINAL POSITION ASSURANCE (TPA) SECONDARY LOCK.
  - FOR APPLICATION DATA SEE THE INDIVIDUAL APPLICATION DRAWINGS.

DWG TYPE: PART DRAWING

STYLE: [ ]

VOLUME (QTY): [ ] DISTR CODE: [ ]

UNLESS OTHERWISE SPECIFIED

THIS DOCUMENT IS IN ACCORDANCE WITH ASME Y14.5M-1994 IS DESIGNED BY THE DIMENSIONAL DIMENSIONS AND TOLERANCING ADDENDUM-2011. SEPARATE PATTERNING OF FEATURES MAY BE USED SEPARATELY, REGARDLESS OF DATUM REFERENCES.

ALL DIMENSIONS ARE IN MILLIMETERS

REFERENCE: [ ]

THIRD ANGLE PROJECTION: [ ]

DO NOT SCALE: [ ]

USE MATH DATA: [ ]

**DELPHI**  
DELPHI PACKARD ELECTRICAL/ELECTRONIC ARCHITECTURE  
WARREN, OH

DR	DATE
APV01 F. MIRANDA	21SE99
APV02 G. B. IZQUIERDO	21SE99
APV03 MAL CULP	08OC99
APV04	
APV05	

SUBSTANCES OF CONCERN AND RECYCLED CONTENT PER DELPHI 10949001

MATERIAL: [ ]  
SEE DRAWING

DRAWING NAME: TAXI ASM CONN F 6T 150 SLD

DRAWING NUMBER: 15355206

SIZE	SCALE	FRAME NO	SHEET NO	REV	N/P
A1	2:1	1	OF 1	1	OF 1

ASSEMBLY PART NO	REV	N/P	STATUS	RESTRICTED USAGE	REPLACE BY	TYPE	CONNECTOR PART NO	PLR	CONN SEAL
13827319	01	-	-	-	-	102	13827317	15326824	15326825
13827318	01	-	-	-	-	101	13827316	15326824	15326825
13519912	01	AD	-	-	-	102	13519911	15326824	15326825
13520906	01	AD	-	-	-	101	13520905	15326824	15326825
15355208	04	AE	-	RESTRICTED	13519912	102	1535204	15326824	15326825
15355207	04	AE	-	RESTRICTED	13520906	101	15355203	15326824	15326825

DIMENSIONAL RANGE (MM)	TOLERANCE UNLESS OTHERWISE SPECIFIED	ANGULAR TOLERANCE (°)
FROM > 0	> 20	> 70
TO 20	10	100
	100	150
	150	200
	200	300
	300	400
	40.15	40.2
	40.3	40.4
	40.5	40.6
	40.8	41
	41	41.2