

RECOMMENDED MATING BLADE CONFIGURATION
SCALE 10:1

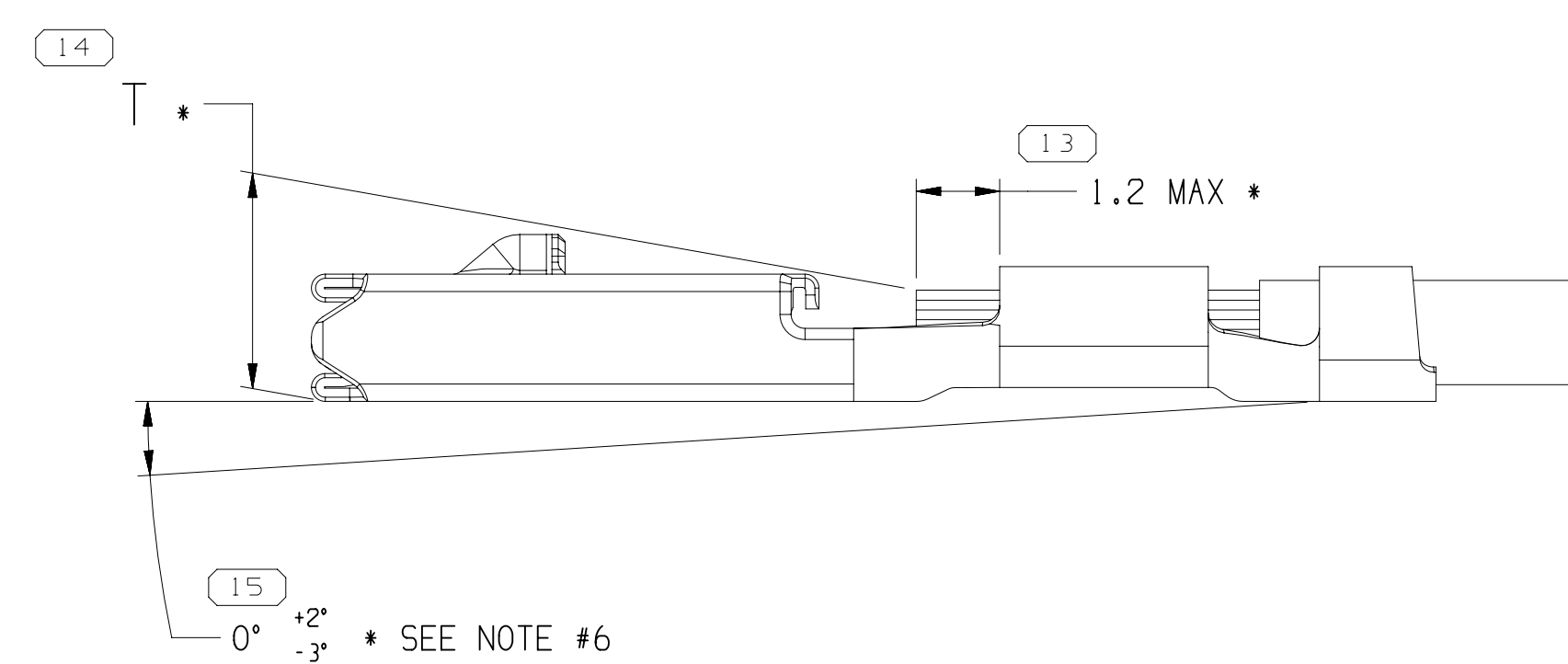

TERMINAL, CABLE CRIMP ALIGNMENT & POSITION

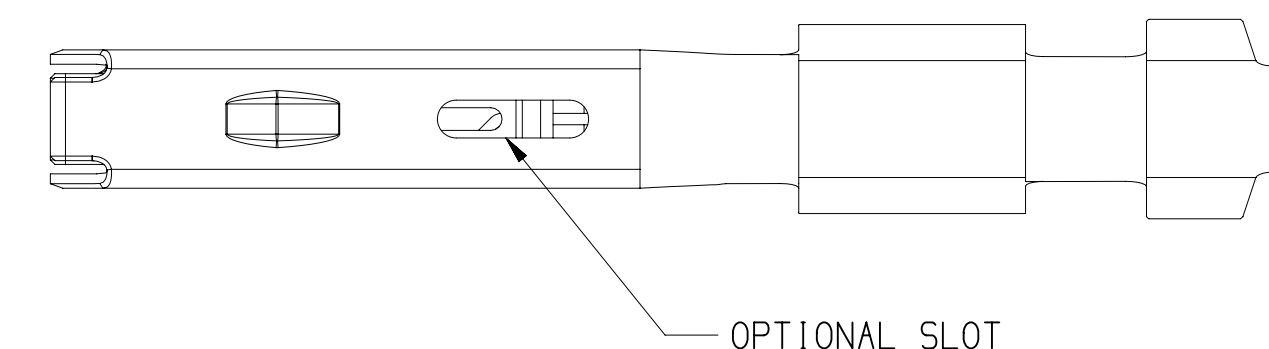
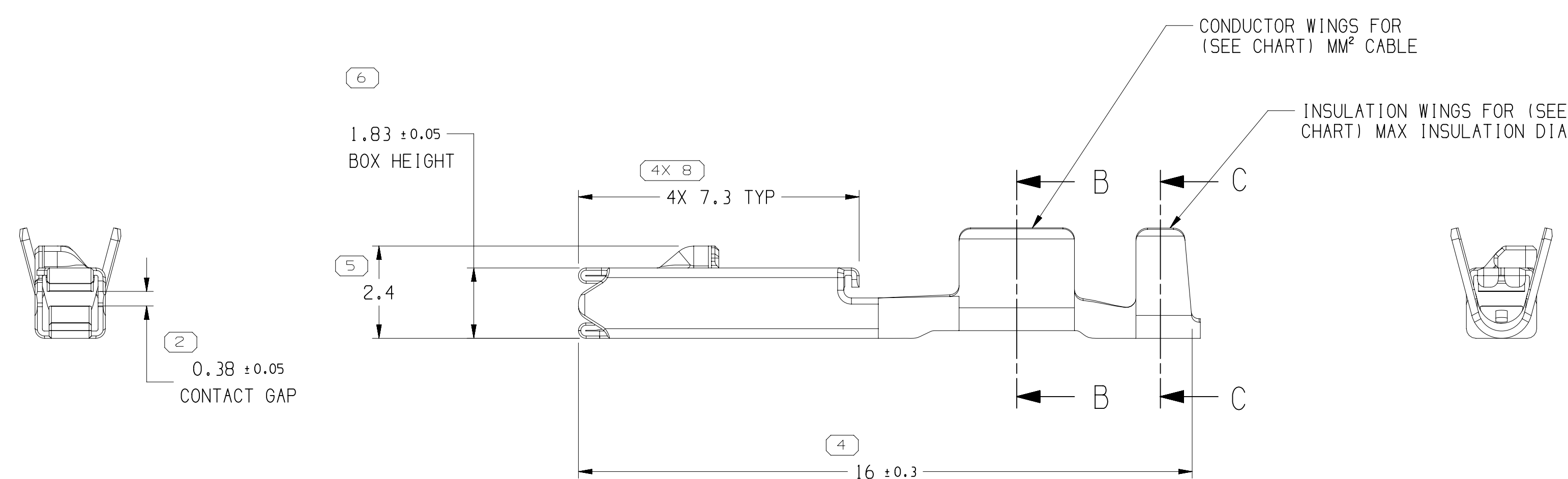
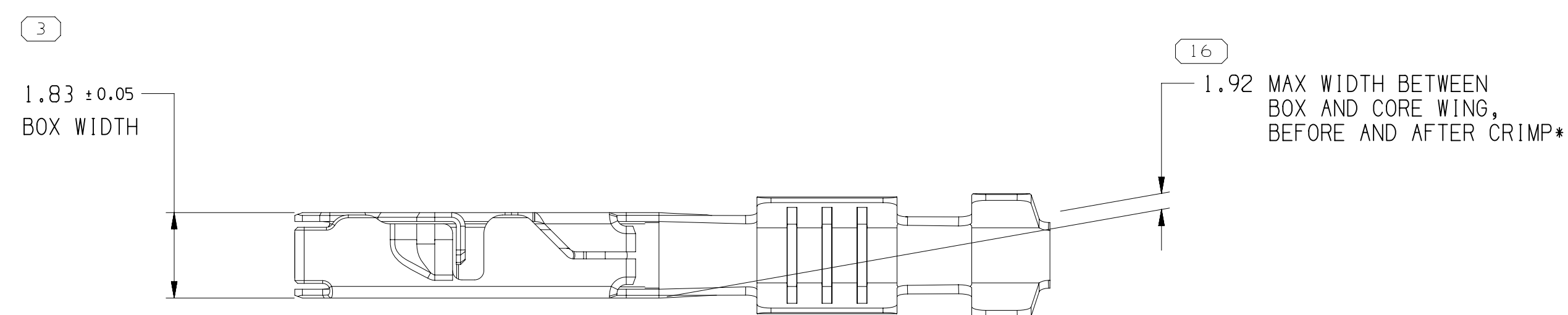
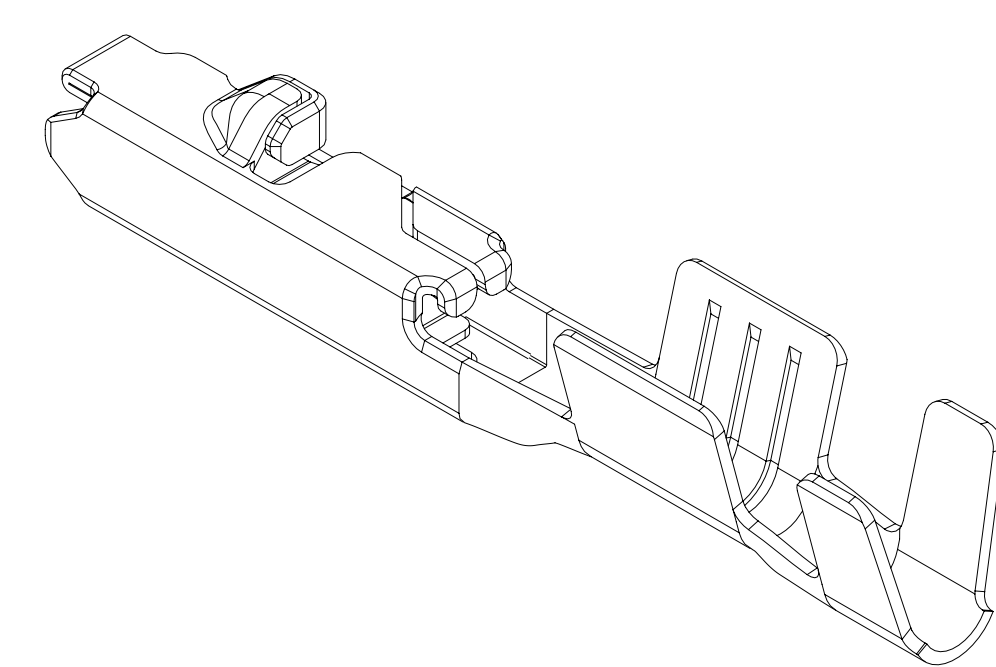

SYMBOL DEFINITION		TOTAL NO OF INSPECTIONS REQUIRED
A DIMENSION WITHOUT AN INSPECTION REPORT SYMBOL DOES NOT REQUIRE INSPECTION. IT MAY BE CONTROLLED ON THE INDIVIDUAL COMPONENT DRAWING.		19
	LAST NO. USED	17

MISSING SYMBOLS		REVISION HISTORY		AUTH	DR	APVD	APVD			
DATE	STG	REV	N/P	CHG	ZONE					
28FE19	R	01	-	-		ALL PARTS - RELEASED PART DRAWING	442472	LVD	RBS	RBS
29NO19	R	02	-	-		ALL PARTS - ADDED CONTACT PLATING I.D. INFO TO CHART; 35072399 - SIZE WAS 0.35-0.5 & DIA WAS 1.47-1.9; 3541001B - RELEASED	550373	LVD	JAA	RBS
23JA20	R	03	-	-		35072399 & 35072400 - UPDATED PART AVAILABILITY	550704	DAG	JAA	DMS
31AU20	R	04	-	-		35072401 - UPDATED PART AVAILABILITY	552382	LGD	JAA	DMS

NOTES

- UNLESS OTHERWISE SPECIFIED AND/OR INDICATED:
DIMENSIONS ARE TO FACE OF VIEW SHOWN AND AUTOMATICALLY ROUNDED BY COMPUTER FOR INSPECTION (SEE MATH MODEL FOR PRECISE DIMENSIONS). FOR ALL OTHER DIMENSIONS NOT SHOWN BUT REQUIRED FOR TOOL BUILD, SEE MATH MODEL FOR PRECISE TOOL PATH DATA.
- RECOMMENDED MATING BLADE THICKNESS 0.6 ± 0.03 MM OR 0.64 ± 0.03 MM
RECOMMENDED MATING BLADE WIDTH NOT TO EXCEED 1.2 MM AND NO LESS THAN 0.61 MM.
- MAXIMUM CURRENT CAPACITY IS 10 AMPS WITH 0.8 MM² COPPER CABLE.
- CRIMP DIMENSION FROM THE BACK OF THE CORE WING (INCLUDES THE FLARE OUT FROM THE CORE WING) TO THE END OF THE INSULATION WING.
2.05 MM MAX WIDTH, 2.1 MM MAX HEIGHT FOR CABLE SIZE UP TO 1.9 MM O.D.
2.35 MM MAX WIDTH, 2.40 MM MAX HEIGHT FOR CABLE SIZE BETWEEN 1.86 TO 2.25 MM O.D.
2.67 MM MAX WIDTH, 2.67 MM MAX HEIGHT FOR CABLE SIZE BETWEEN 2.25 TO 2.40 MM O.D.
- * DENOTES DIMENSIONS MADE AT CUT-OFF & CRIMP DIE.
- PLUS ANGLE IS WING BOTTOM SURFACE ROTATED COUNTERCLOCKWISE AGAINST THE BOX BOTTOM SURFACE.
- TERMINAL HAS TO MATE TO A MALE TERMINAL WITH PRECIOUS METAL PLATING CONTACT.
- DO NOT PROBE, TEST OR OTHERWISE CONTACT THE INTERIOR REGION (THE SPRING OR ANY MOVING PART) OF THIS TERMINAL. SEVERE DAMAGE CAN OCCUR, COMPROMISING THE PERFORMANCE OF THE ELECTRICAL INTERFACE.

PART NO	REV	N/P	MAT'L SIZE	MAT'L SPEC	CONTACT PLATING	CONTACT PLATING I.D.	SIZE (MM²)	ID	DIA	B _{1±0.2}	B _{2±0.3}	(H ₁)	(H ₂)	T MAX
3541001B	01	-	0.19 X 26.78	GOLD PLATED COPPER ALLOY	GOLD/PALLADIUM	AU	0.35	22	1.2 - 1.7	1.8	2.4	1.75	2.4	1.4
35072401	01	AB	0.19 X 26.78	GOLD/PALLADIUM	GOLD/PALLADIUM	AU	0.8 - 1	17	1.86 - 2.4	2.5	2.8	2.7	2.8	1.6
35072400	01	AB	0.19 X 26.78	GOLD PLATED COPPER ALLOY	GOLD/PALLADIUM	AU	0.75 - 0.8	18	1.7 - 1.9	2.5	2.5	2.7	2.5	1.5
35072399	01	AB	0.19 X 26.78	GOLD PLATED COPPER ALLOY	GOLD/PALLADIUM	AU	0.5	21	1.4 - 1.9	2	2.4	2.1	2.4	1.4

FROM	TO	TOLERANCE UNLESS OTHERWISE SPECIFIED	ANGULAR TOLERANCE
0	12	±0.1	±2°
12	25	±0.2	
25	∞	±0.3	

APTIV
CONNECTION SYSTEMS
WARREN, OH
COPYRIGHT 2019 APTIV, ALL RIGHTS RESERVED.
THIS DRAWING IS THE PROPERTY OF APTIV AND CONTAINS APTIV CONFIDENTIAL INFORMATION. THE REPRODUCTION, DISTRIBUTION AND UTILIZATION OF THIS DOCUMENT OR ITS RELATED CAD DATA, AS WELL AS COMMUNICATION OF ANY CONTENT TO OTHERS, WITHOUT EXPRESS AUTHORIZATION, IS PROHIBITED.

DR: LUIS VILLARREAL
APVD: ROBERT B SNADER
DATE: 28FE19

DR: ROBERT B SNADER
APVD: ROBERT B SNADER
DATE: 01MR19

DATE: 01MR19

THIS DOCUMENT IS IN ACCORDANCE WITH ASME Y14.5-2019. SEE APTIV ENGINEERING DESIGN STANDARD 06-2017 FOR ISO 1101/2004 RECOMMENDATION REQUIREMENTS.

ALL DIMENSIONS ARE IN MILLIMETERS

THIRD ANGLE PROJECTION
DO NOT SCALE
USE MATH DATA

REFERENCE

DRAWING NAME: TAXI TERM F OCS 1.2
DRAWING NUMBER: 13543112
SIZE: A0
SCALE: 10:1
FRAME NO: 1 OF 1
SHEET NO: 9 OF 9
STG REV: R 04