

MATERIAL SPECIFICATIONS

RECOMMENDED:
BASE METAL - 10A-210, GILDING, EXTRA SPRING TEMPER
PLATING - 0,0050±0,0025 MM THICK TIN
MINIMUM ELECTRICAL CONDUCTIVITY - > 20% IACS @ 20°C, USE OF A MATERIAL WITH CONDUCTIVITY > 20% IACS MUST BE APPROVED BY PACKED ELECTRIC MATERIALS ENGINEERING.

DESIRABLE STRENGTH - 407 MPa
PLATING - FOR LOW ENERGY (< 5V) AND NON-PASSENER COMPARTMENT POWER CIRCUITS, 0,0050±0,0025 MM THICK TIN OVER MATERIALS CONTAINING 10% OR MORE ZINC. AN UNDERLAYER OF COPPER 0,0050±0,0025 MM THICK IS REQUIRED.

BLADE THICKNESS
10A-210: 0,813 ± 0,025
TIN PLATED: 0,823 ± 0,030

MATING BLADE INFORMATION
SCALE B11

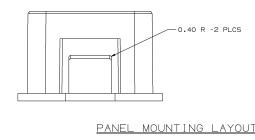
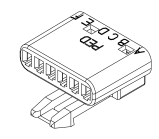
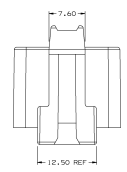
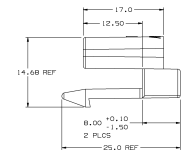
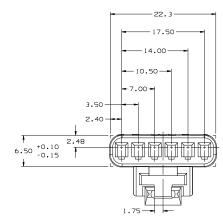
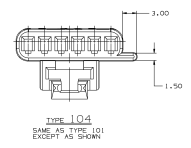
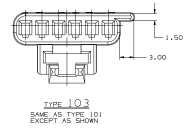
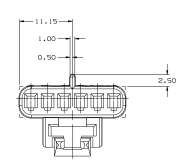
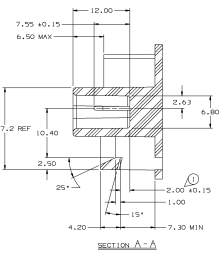
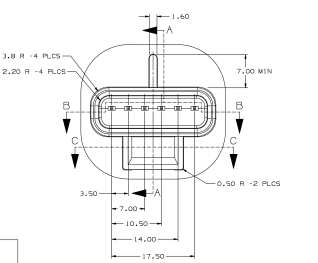
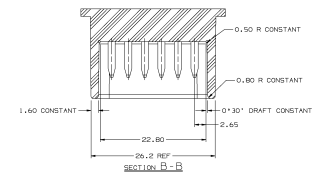
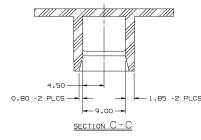
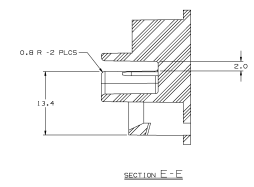
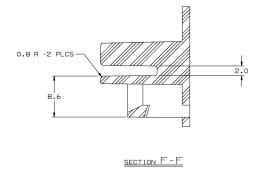
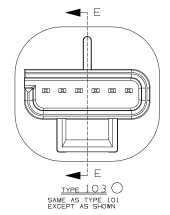
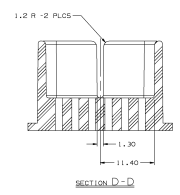
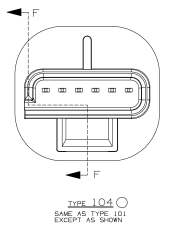
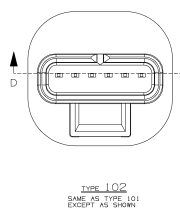

NOTES

- UNLESS OTHERWISE SPECIFIED AND/OR INDICATED, DIMENSIONS ARE TO FACE OF VIEW SHOWN AND AUTOMATICALLY ROUNDED BY COMPUTER FOR INSPECTION. (SEE MATERIAL MODEL FOR PRECISE DIMENSIONS)
- "DIM" DENOTES DIMENSIONS AND CHARACTERISTICS THAT ARE IMPORTANT TO THE FUNCTION AND/OR PROCESSING OF THE PART THAT HAVE SPECIAL ACCEPTANCE CRITERIA FOR PRODUCTION APPROVAL. THIS DRAWING HAS 12 SKETCHES.
- TERMINALS MUST WITHSTAND A MINIMUM PUSHOUT FORCE OF 50N (10 LBS)
- RECOMMENDED BODY MATERIAL: POLYESTER OR EQUIVALENT THERMOPLASTIC

NOTES

- UNLESS OTHERWISE SPECIFIED AND/OR INDICATED, DIMENSIONS ARE TO FACE OF VIEW SHOWN AND AUTOMATICALLY ROUNDED BY COMPUTER FOR INSPECTION. (SEE MATERIAL MODEL FOR PRECISE DIMENSIONS)
- MATING COMPONENTS: PRIMER COIL LOCK (MIL-STD-204A/2022) OR EQUIVALENT TERMINAL: 1024783 OR EQUIVALENT MAX. INSULATION COIL MUST BE LESS THAN 2,00 HIGHER AND 2,00 HIGHER SECONDARY TERMINAL AND 2,00 HIGHER OR EQUIVALENT EXISTING POSITION INSURANCE LOCK 1025834 OR EQUIVALENT
- DIMENSIONS MARKED "REF" ARE FOR REFERENCE ONLY AND NO TOLERANCE LIMITS ARE ESTABLISHED.

PART NO	REV	STATUS	TYPE	MATERIAL	SPEC & COLOR	VOLUME
12177012	A		104	10100104	PBT-BLK	2-035
12177011	A		103	10100103	PBT-NAT	2-035
12186013	A		102	10100102	PBT-BLK	1-163
12054860	C		101	10100101	PBT-BLK	1-195

REV	DATE	BY	CHKD	APPR	DESCRIPTION
1					INITIAL RELEASE
2					ALL PARTS - NEW SUPPLIERS
3					SPEC. & POLYESTER MATL.
4					SPEC. NO REV UPDATE
5					REWORK
6					11/20/2014
7					TYPE 103 HAS TYPE 104 &
8					TYPE 104 HAS 101 IN
9					PANEL MOUNTING LAYOUT
10					11/20/2014

REV	DATE	BY	CHKD	APPR	DESCRIPTION
1					INITIAL RELEASE
2					ALL PARTS - NEW SUPPLIERS
3					SPEC. & POLYESTER MATL.
4					SPEC. NO REV UPDATE
5					REWORK
6					11/20/2014
7					TYPE 103 HAS TYPE 104 &
8					TYPE 104 HAS 101 IN
9					PANEL MOUNTING LAYOUT
10					11/20/2014

1217 7018