

SYMBOL DEFINITION		MISSING SYMBOLS	
A DIMENSION WITHOUT AN INSPECTION REPORT SYMBOL () DOES NOT REQUIRE INSPECTION. IT MAY BE CONTROLLED ON THE INDIVIDUAL COMPONENT DRAWING.	TOTAL NO OF INSPECTIONS REQUIRED	13	NO MISSING SYMBOL NUMBER
	LAST NO. USED	13	

DWG STATUS				ZONE	REVISION HISTORY	AUTH	DR	APV/D
DATE	STG	REV	R/P/CHG					
25NO99	R	01	-	-	ALL PARTS - REDRAWN TO PD	196858	CMP	GMC DN
170001	R	02	-	-	ALL PARTS - ADDED OPTIONAL CONSTRUCTION & MATERIAL RECYCLING CODE NOTES & REVISED CAVITIES ID LOCATIONS	215985	EOV	EOV GMC
045E02	R	03	-	-	ALL PARTS - SECONDARY TERMINAL LOCK NOTE WAS 12047664	230019	RVP	RVP GMC
23NO05	R	04	-	-	ALL PARTS - ADDED NOTE 7	274632	BB	BB BB
30MR06	R	05	-	-	12059249 - MAT'L SPEC WAS M3592002	278565	GPS	FRG JGS
10FE09	R	06	-	-	ALL PARTS - ADDED APPLICATION DATA NOTE: 13685168 - RELEASED	407293	MGE	MGE MGE

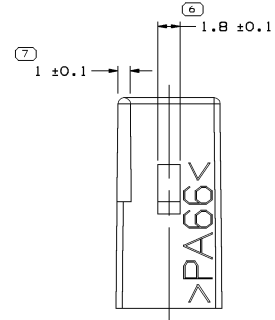
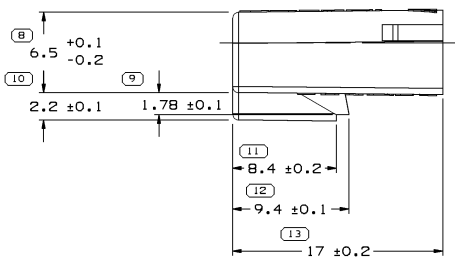
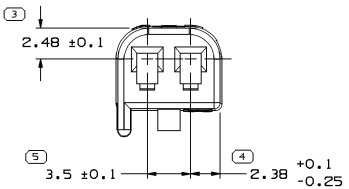
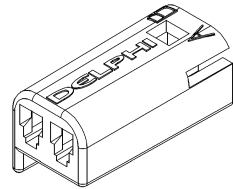
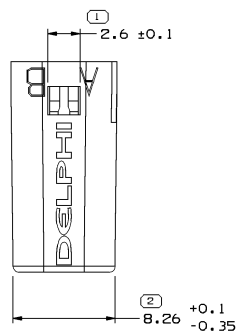

NOTES

- UNLESS OTHERWISE SPECIFIED AND/OR INDICATED:
DIMENSIONS ARE TO FACE OF VIEW SHOWN AND AUTOMATICALLY ROUNDED BY COMPUTER FOR INSPECTION (SEE MATH MODEL FOR PRECISE DIMENSIONS). FOR ALL OTHER DIMENSIONS NOT SHOWN BUT REQUIRED FOR TOOL BUILD, SEE MATH MODEL FOR PRECISE TOOL PATH DATA.
- MATERIAL RECYCLING CODE PER ISO 11469. (2.3)X(0.1) CHARACTERS AS SHOWN TO BE LOCATED ON ANY EXTERIOR SURFACE. OPTIONAL CONSTRUCTION TO BE NO MATERIAL RECYCLING CODE.
- THIS PART IS NOT CONTROLLED FOR AUTOMATIC FEEDING.
- (2.3)X(0.1) DELPHI CORPORATE BRAND TO BE LOCATED ON ANY EXTERIOR SURFACE, PREFERABLY VISIBLE AT FINAL ASSEMBLY. OPTIONAL CONSTRUCTION TO BE "PED" OR NO LOGO.
- FOR MATING CONFIGURATION REQUIREMENTS, SEE PART NUMBER 13548762.
- FOR APPLICATION DATA SEE THE INDIVIDUAL APPLICATION DRAWINGS.

13685168	01	-	-	POLYAMIDE COMPOUND ORANGE	0.583
12059249	02	AA	-	POLYAMIDE COMPOUND CREAM	0.583
12059247	A5	-	-	POLYAMIDE COMPOUND GRAY	0.583
12047662	A6	-	-	POLYAMIDE COMPOUND BLACK	0.583
PART NO	REV	N/P	STATUS	MATERIAL SPECIFICATION AND COLOR	VOLUME CM ³

(13) PROCESS SENSITIVE DIMENSION
DIMENSIONS ENCLOSED IN () INDICATE REFERENCE DIMENSIONS AND NO TOLERANCE LIMITS ARE ESTABLISHED

DIMENSIONAL RANGE (MM)		SURF. FT.	
FROM	TO	FROM	TO
> 0	> 30	> 70	> 100
> 30	> 100	> 100	> 200
> 100	> 200	> 200	> 300
> 200	> 300	> 300	> 400
TOLERANCE UNLESS OTHERWISE SPECIFIED			
±0.15	±0.2	±0.3	±0.4
±0.5	±0.6	±0.8	±1
±1.2	±1.5	±2	±2.5
ANGULAR TOLERANCE 20'			

DWG TYPE: PART DRAWING

STYLE: []

VOLUME (CM³): SEE CHART

DISTR CODE: D

UNLESS OTHERWISE SPECIFIED

THIS DOCUMENT IS IN ACCORDANCE WITH ASME Y14.5M-1994 AS AMENDED BY THE 2003 DIMENSIONING AND TOLERANCING AMENDMENT - 1997. ALL GEOMETRIC TOLERANCES AND RELATED DATUMS APPLY PER ASME Y14.5M-1994. THIS DOCUMENT DOES NOT APPLY WHEN RELATIONSHIP BETWEEN FEATURES IS ESTABLISHED BY ORIENTATION OR LOCATION TOLERANCES. SEPARATE POSITION CALLOUTS MAY BE GAUGED SEPARATELY, REGARDLESS OF DATUM REFERENCE. ALL DIMENSIONS ARE IN MILLIMETERS.

REFERENCE: []

THIRD ANGLE PROJECTION

DO NOT SCALE

USE MATH DATA

NDX

DELPHI

DELPHI PACKARD ELECTRICAL/ELECTRONIC ARCHITECTURE
WARREN, OH

DR	DATE
APV/D1 C.MIRANDA	25NO99
APV/D2 G.MACIAS	20JAO0
APV/D3 D.NAVARRO	26JAO0
APV/D4	
APV/D5	

NATERIAL: SUBSTANCES OF CONCERN AND RECYCLED CONTENT PER DELPHI 1094900

SEE CHART

DRAWING NAME: TAXI CONN F M/P 150

DRAWING NUMBER: 12059281

SIZE	SCALE	FRAME NO	SHEET NO	REV	N/P
A1	5:1	1	1 OF 1	R	06