

SYMBOL DEFINITION		MISSING NUMBERS
A DIMENSION WITHOUT AN INSPECTION REPORT SYMBOL () DOES NOT REQUIRE INSPECTION. IT MAY BE CONTROLLED ON AN INDIVIDUAL COMPONENT DRAWING.	TOTAL NO. OF SYMBOLS ON DRAWING	7
	LAST NO. USED	10

DWG STATUS			ZONE	REVISION HISTORY	AUTH	DR	APVD	DATE	
DATE	STG	REV							
08AP99	R	01	-	-	108844	PHC	AUG	08	
08N001	R	02	-	-	12089188	MRL	MRL	DLB	
18AU03	R	03	-	-	12020801, 12089188 & 12124580	ECB	AUG	JMP	
23JA07	R	04	-	-	ALL ACTIVE PARTS - UPDATED PDM ATTRIBUTES	400088	JBD	AUG	EJH

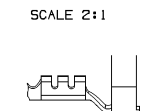

TYPE 102
SAME AS TYPE 101
EXCEPT AS SHOWN

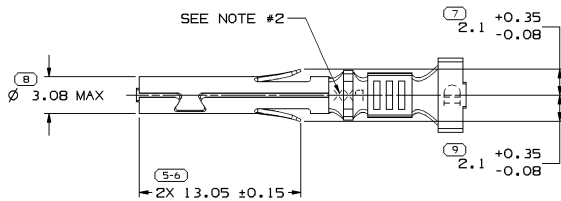
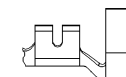

TYPE 103
SAME AS TYPE 101
EXCEPT AS SHOWN

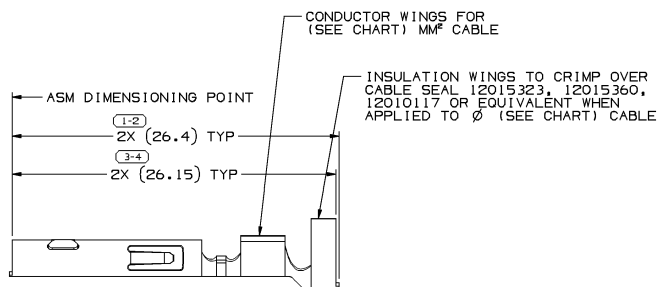

TYPE 101

NOTES

- UNLESS OTHERWISE SPECIFIED AND/OR INDICATED, DIMENSIONS ARE TO FACE OF VIEW SHOWN AND AUTOMATICALLY ROUNDED BY COMPUTER FOR INSPECTION. (SEE MATH MODEL FOR PRECISE DIMENSIONS.) FOR ALL OTHER DIMENSIONS NOT SHOWN BUT REQUIRED FOR TOOL BUILD, SEE MATH MODEL FOR PRECISE TOOL PATH DATA.
- "PXX" INDICATES "P" PLUS LAST TWO DIGITS OF MAKE DIE SERIES NUMBER (P01, P02, P03, ETC.).
- TERMINAL DESIGNED FOR 3 MM² CABLE. TERMINAL IS RATED AT 20 AMPERES. -DO NOT EXCEED RATED CURRENT.

APPLICATION NOTE:
THESE TERMINALS DESIGNED FOR USE IN WEATHER PACK TOWER CONNECTORS WITH STABILIZERS LOCATED AT 11.25MM FROM THE LOCK SHOULDER.

PART NO	STG	REV	N/P	STATUS	MAT'L SIZE	MAT'L SPEC	CABLE SIZE (MM ²)	MAX CABLE Ø	ID TYPE
12124581	R	B2	-		0.32X35.33	P1519358 425 TIN BRS EX HD SN PLTD	SEE NOTE #3	3.96	11 103 4.6
12124580	R	02	AC		0.32X35.33	P1519358 425 TIN BRS EX HD SN PLTD	2 - 1	3.96	15 103 3.6
12089188	R	A3	-		0.32X35.33	P1519358 425 TIN BRS EX HD SN PLTD	0.8 - 0.5	3.11	19 102 3
12034051	R	B7	-	OBSOLETE	0.32X35.33	P1519358 425 TIN BRS EX HD SN PLTD	0.8 - 0.5	3.11	19 102 3
12020801	R	C5	-		0.32X35.33	P1519358 425 TIN BRS EX HD SN PLTD	0.35	1.86	22 102 2.2
12015917	R	01	-	OBSOLETE	0.32X35.33	P1519358 425 TIN BRS EX HD SN PLTD	SEE NOTE #3	3.96	11 101 4.6
12010183	R	P8	-	OBSOLETE	0.32X35.33	P1519358 425 TIN BRS EX HD SN PLTD	0.8 - 0.5	3.11	19 101 3
12010182	R	P8	-	OBSOLETE	0.32X35.33	P1519358 425 TIN BRS EX HD SN PLTD	2 - 1	3.96	15 101 3.6

DIMENSIONAL RANGE (MM)		CHART D
FROM	0	>12
TO	15	
TOLERANCE UNLESS OTHERWISE SPECIFIED	±0.1	±0.2
	±0.15	±0.2

THIRD ANGLE PROJECTION	DO NOT SCALE	USE MATH DATA

DELPHI

DELPHI PACKARD ELECTRIC SYSTEMS
WARREN, OH

DR	DATE
APVD1 P H CASTRILLON	08AP99
APVD2 A UGALDE G	15AP99
APVD3 G ORANTES	15AP99
APVD4	
APVD5	

WATERIAL: SEE CHART

DRAWING NAME: TAXI TERM F W/P SEALED

DRAWING NUMBER: 12010184

SIZE: A1 SCALE: 1 OF 1 FRAME NO: 1 OF 3 SHEET NO: 1 OF 4