

## Structure / 構造

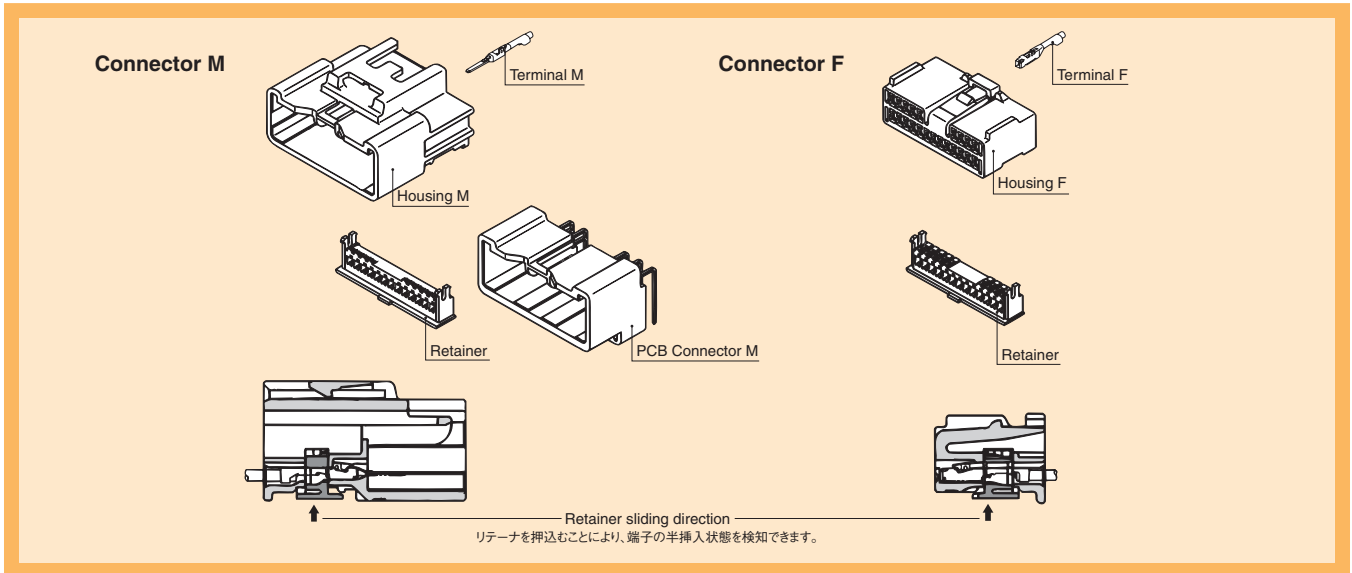

## Terminal (mm)

050

Cable size (mm <sup>2</sup> ) 適用電線サイズ	0.3~0.5
Cable overall diameter (mm) 電線仕上り外径	1.4~2.1
Material 材質	Brass 黄銅
Surface treatment 表面処理	Tin-plated Snメッキ
Reel (piece) リール(個)	5000
Thickness (mm) 板厚	0.3

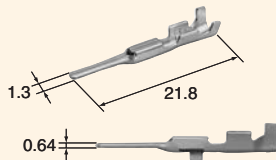

M(1500-0181)

Cable size (mm <sup>2</sup> ) 適用電線サイズ	0.3~0.5
Cable overall diameter (mm) 電線仕上り外径	1.4~2.1
Material 材質	Copper alloy 銅合金
Surface treatment 表面処理	Tin-plated Snメッキ
Reel (piece) リール(個)	5000
Thickness (mm) 板厚	0.2

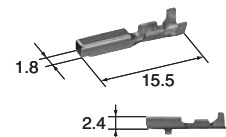

F(8100-0544)

## Housing (mm)

Material / P.B.T.  
Color / Natural

Ref: Terminal part No. A-15  
ターミナル参照頁

Ref: Terminal part No. A-15  
ターミナル参照頁

3way

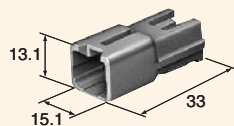

M(6098-0911)

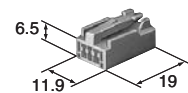

F(6098-0922)

3way

Ref: Terminal part No.  
ターミナル参照頁 A-15  
Note  
備考 With body fastening clamp.  
回り止めクランプ付

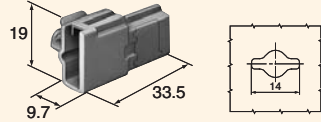
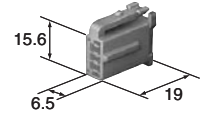

Plate thickness range for clamp :  
t=0.7~2.2

**M(6098-0963)**

Ref: Terminal part No.  
ターミナル参照頁 A-15



**F(6098-0964)**

4way

Ref: Terminal part No.  
ターミナル参照頁 A-15

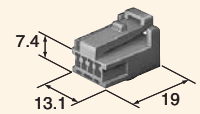

**F(6098-0923)**

Ref: Terminal part No.  
ターミナル参照頁 A-15

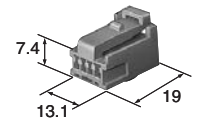

**F(6098-0924)**

6way

Ref: Terminal part No.  
ターミナル参照頁 A-15  
Note  
備考 With body fastening clamp.  
回り止めクランプ付

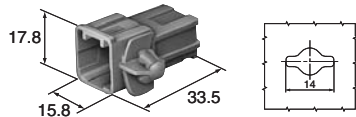
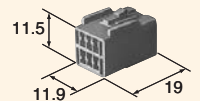

Plate thickness range for clamp :  
t=0.7~2.2

**M(6098-0907)**

Ref: Terminal part No.  
ターミナル参照頁 A-15



**F(6098-0918)**

12way

Ref: Terminal part No.  
ターミナル参照頁 A-15

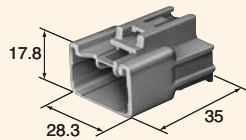

**M(6098-0905)**

Ref: Terminal part No.  
ターミナル参照頁 A-15

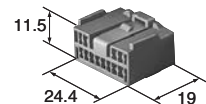

**F(6098-0914)**

20way

Ref: Terminal part No.  
ターミナル参照頁 A-15

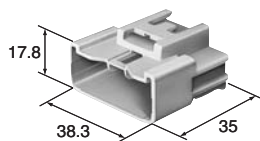

**M(6098-1246)**

Ref: Terminal part No.  
ターミナル参照頁 A-15

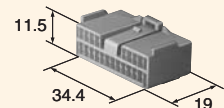

**F(6098-1065)**

Plate thickness range for clamp=クランプ適用板厚

22way

Ref: Terminal part No.  
ターミナル参照頁 A-15

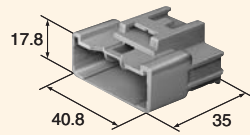

**M(6098-0903)**

Ref: Terminal part No.  
ターミナル参照頁 A-15

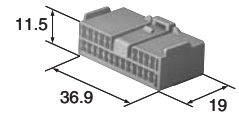

**F(6098-0916)**

Ref: Terminal part No.  
ターミナル参照頁 A-15

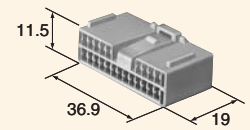

**F(6098-1250)**

40way

Ref: Terminal part No.  
ターミナル参照頁 A-15

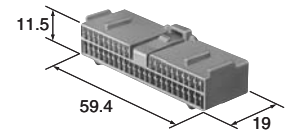

**F(6098-1235)**