

SL SEALED SERIES for STANDARD

1.5mm (060)

Structure

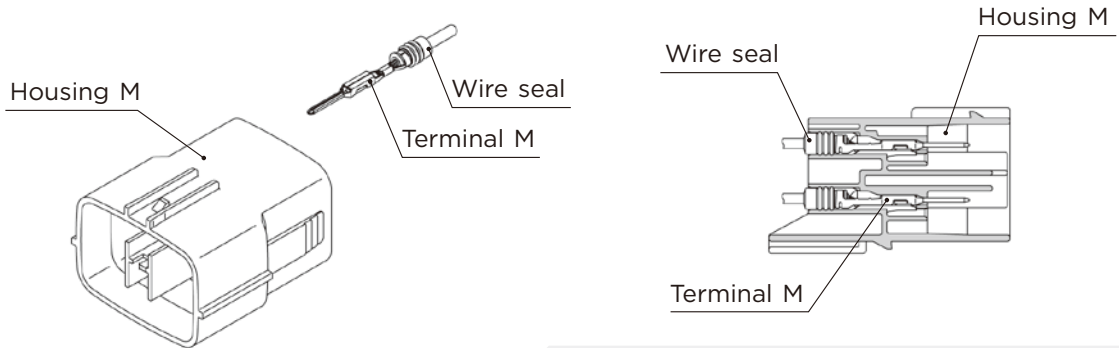

Connector M

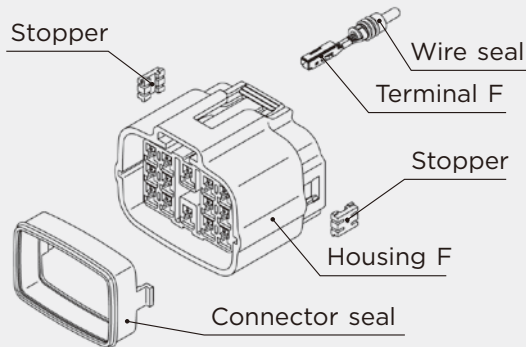

Connector F

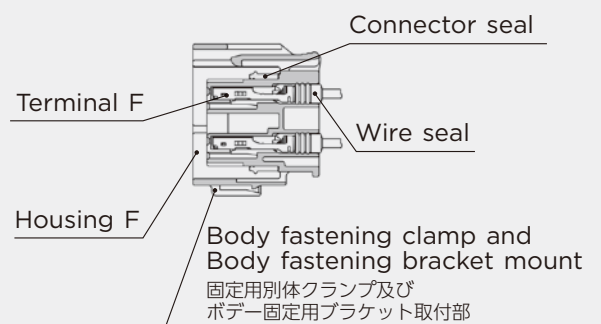

1.5mm (060)

(E)	(J)
Cable size	: 適用電線サイズ
Cable overall diameter	: 電線仕上り外径
Heat-resistant copper alloy	: 耐熱銅合金
Brass	: 黄銅
Surface treatment	: 表面処理
Gold-plated	: Auメッキ
Tin-plated	: Snメッキ

Terminal (UNIT: mm)

※ For terminal selection, please contact our sales staff.

※ターミナル選定にあたっては、必ず弊社営業担当にお問い合わせください。

(S)

Cable size (mm²)	0.3~0.5
Material	Heat-resistant copper alloy
Surface treatment	Tin-plated

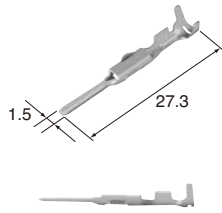
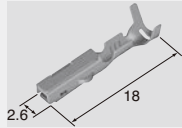
**M (8100-3388)**

Cable size (mm²)	0.3~0.5
Material	Heat-resistant copper alloy
Surface treatment	Tin-plated

F (8100-3397)**(S)****Au**

Cable size (mm²)	0.3~0.5
Material	Heat-resistant copper alloy
Surface treatment	Gold-plated

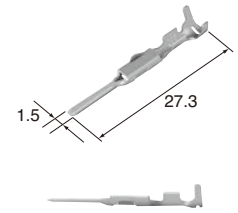
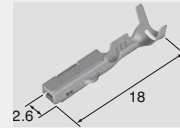
**M (8100-3504)**

Cable size (mm²)	0.3~0.5
Material	Heat-resistant copper alloy
Surface treatment	Gold-plated

F (8100-3402)**(M)**

Cable size (mm²)	0.75~0.85
Material	Heat-resistant copper alloy
Surface treatment	Tin-plated

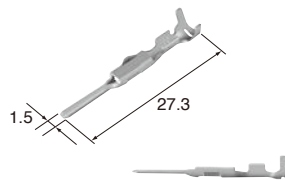
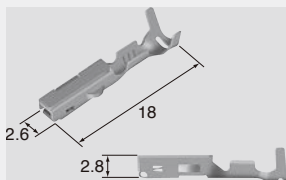
**M (8100-3389)**

Cable size (mm²)	0.75~0.85
Material	Heat-resistant copper alloy
Surface treatment	Tin-plated

F (8100-3398)**(M)****Au****M (8100-3403)**

Cable size (mm²)	0.75~0.85
Material	Heat-resistant copper alloy
Surface treatment	Gold-plated

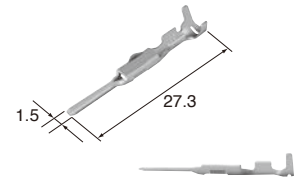
**J-03**

SL SEALED SERIES

(L)

Cable size (mm²)	1.25~2.0
Material	Heat-resistant copper alloy
Surface treatment	Tin-plated

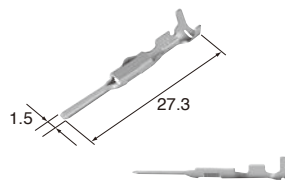
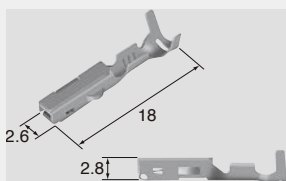
**M (8100-3390)**

Cable size (mm²)	1.25~2.0
Material	Heat-resistant copper alloy
Surface treatment	Tin-plated

F (8100-3399)

1.5mm (060)

Wire seals (UNIT : mm)

Ref; 1.5mm Terminal detail

S (7165-0516) J-07

M (7165-0515) J-07

L (7165-0514) J-07

1.5mm (060)

Dummy plugs (UNIT : mm)

Ref; 1.5mm Dummy plug detail

(7161-9787) B-17

(7165-0193) J-07

J-04

1.5mm (060)

Housing (UNIT : mm)

Ref: Terminal part No. J-02

Ref: wire seal No. J-06

Ref: Dummy plug No. B-17
J-07

Material PBT

2way

Color Black

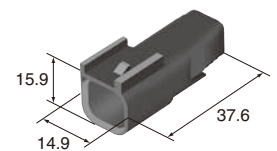

M (6181-6614)

F (6189-1076)

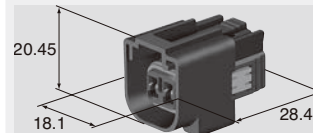

Color Black

2way

Color Dark Gray

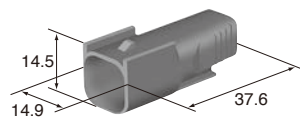

M (6181-6509)

F (6189-1073)

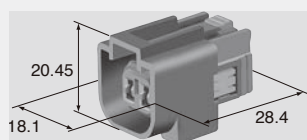

Color Dark Gray

2way

Color Black

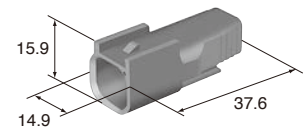

M (6181-6492)

F (6189-1115)

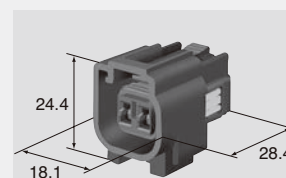

Color Black

Note J-11
Clamp:TYPE1

2way

F (6189-1147)

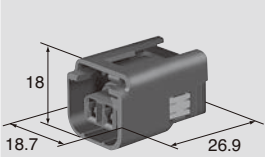

Color Black

2way

F (6189-1144)

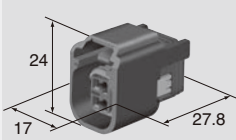

Color Black

2way

F (6189-1150)

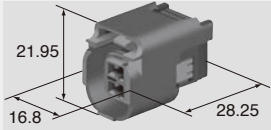

Color Dark Gray

2way

F (6189-1149)

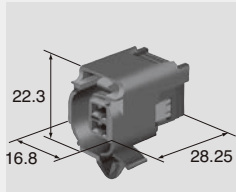

Color Dark Gray

3way

F (6189-7115)

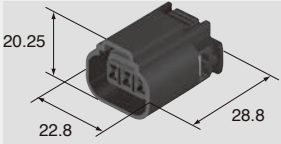

Color Black

14way

Color Dark Gray

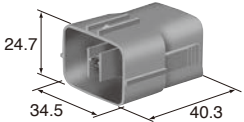

M (6181-0629)

F (6189-7262)

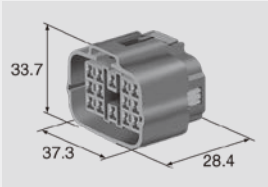

Color Dark Gray

Note J-11
Clamp:TYPE1

J-05

SL SEALED SERIES

SL SEALED SERIES CONNECTOR ACCESSORIES

Mounting clip (mm)

Mounting clip can be installed on the standard type connectors.
 ※ The detail dimensions for the mounting portion are specified on the drawing.

1.5mm 標準・2.3mm 標準・8.0mm 標準のコネクタには、ボデー固定用クランプを必要に応じて取付けることができます。
 ※取付部詳細寸法は、別途図面により規定します。

Type 1

(6810-1584)

Material	PBT
Color	Brown
hole size	7.2×10.2
Plate thickness range for clamp クランプ適合板厚	t=0.7~2.0

