

PART NUMBER	REV	TERMINATOR	FEED TYPE	DESCRIPTION
1530319-1	A	LEADMAKER	MECH POST FEED	CUTS CARRIER
1530319-2	A	BENCH	MECH PRE FEED	CUTS CARRIER
1530319-6	A	LEADMAKER	MECH POST FEED	CONTINUOUS CARRIER
7-1530319-1	A	LEADMAKER	MECH POST FEED	-1 AND SPARE PARTS
7-1530319-2	A	BENCH	MECH PRE FEED	-2 AND SPARE PARTS
7-1530319-6	A	LEADMAKER	MECH POST FEED	-6 AND SPARE PARTS
7-1530319-7	A	-	-	SPARE PARTS KIT

CRIMP DATA		YAZAKI TERMINAL		YAZAKI CRIMP SPECS	
TERMINAL NAME: TERMINAL					
CRIMP	SIZE	TYPE	RANGE		
WIRE	1.52 [.060 IN]	F	0.30-0.50mm ² or 22-20AWG		
INSUL	1.60 [.063 IN]	F	Ø2.54 MAX [.100 IN]		
WIRE STRIP LENGTH 4.00-5.00 [.157-.197 IN]		APPL INSTRUCTIONS 408-8322 & 408-8490			
TERMINAL YAZAKI DATA SHT APPL SPEC		FEED 9.53 [.375 IN]			
TERMINALS APPLIED					
TE PN	MANUF PN				
2113109	7116-1257-02				
WIRE SIZE	CRIMP HEIGHT	REF SETTING			
0.50mm ² or 20AWG	.90 ± 0.05 [.035 ± .002 IN]	C-5			
0.30mm ² or 22AWG	.85 ± 0.05 [.033 ± .002 IN]	D-0			

- △ RECOMMENDED SPARE PARTS.
- △ GREASE RAM, CAM, CAM FOLLOWER AND FEED ROD LIGHTLY.
- △ CERTAIN TERMINALS REQUIRE LUBRICATION. REFER TO THE APPLICATOR INSTRUCTION SHEET FOR MORE INFORMATION.
- 4. LUBRICATE DAILY PER THE APPLICATOR INSTRUCTION SHEET SUPPLIED WITH THE APPLICATOR.

* WARNING
ON INSTALLATION, SET WIRE DISC TO LARGEST WIRE SIZE SETTING. USE OF SETTINGS BELOW MIN. REQUIRED CRIMP HEIGHT SETTING WILL CAUSE DAMAGE TO CRIMP TOOLING.

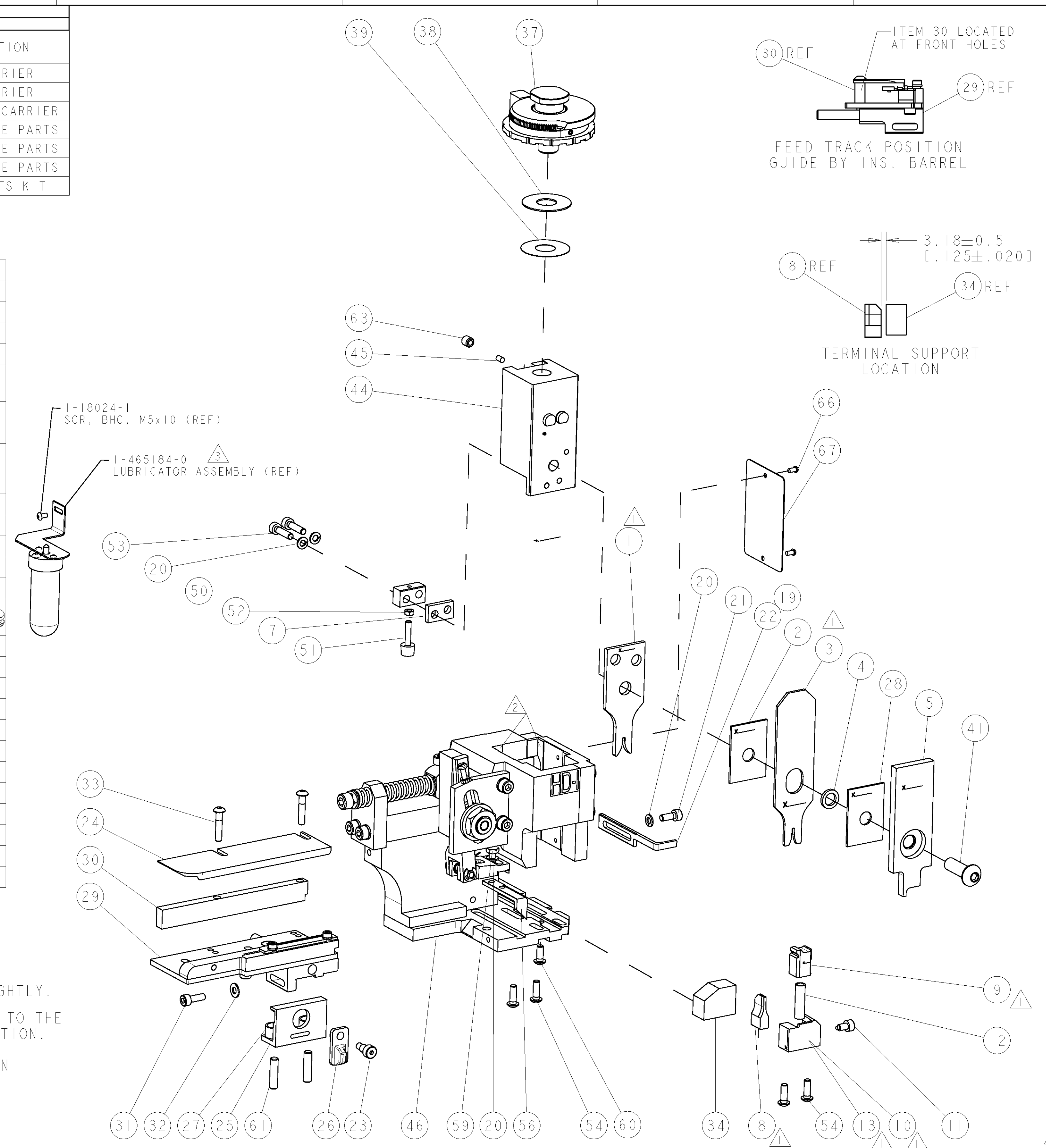
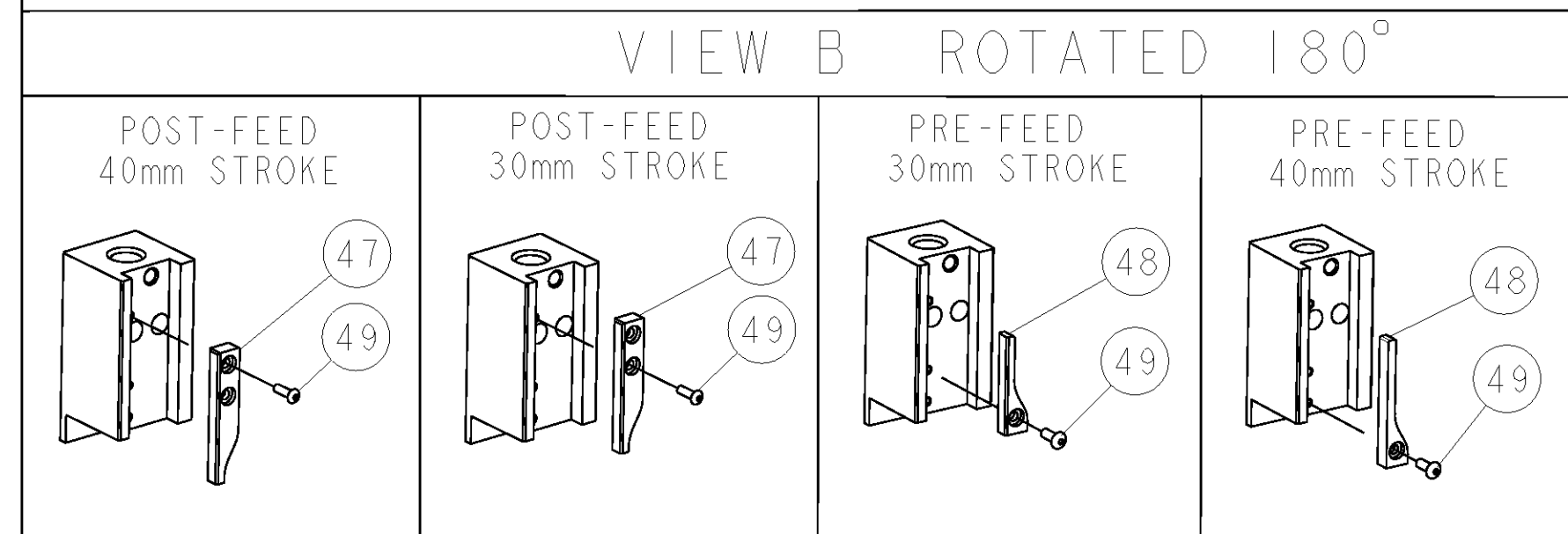

LOC	DIST	REV	DATE	BY	CHK	APPV
A	66	A	09JUN2010	MEH	MEH	

QTY	UNIT	DESCRIPTION	DATE	BY	CHK	APPV	ITEM NO
1		1338705-3					71
1		461264-5					67
2		21017-2					66
1		3-18031-0					63
2		2-18032-5					61
1		18024-7					60
1		5-18022-2					59
1		1338685-1					56
4		18024-8					54
2		1-18023-3					53
1		18030-1					52
1		811242-5					51
1		690753-2					50
1		18024-3					49
1		1338675-1					48
1		1338676-1					47
1		1320999-3					46
1		690191-1					45
1		1633724-1					44
1		2-18024-6					41
1		690125-1					39
1		469367-8					38
1		879103-3					37
1		1320934-3					34
2		1-18024-0					33
1		18027-2					32
1		1-18023-2					31
1		1320908-1					30
1		1633073-1					29
1		1-455888-0					28
2		1-22284-0					27
1		356835-1					26
1		240792-1					25
1		1320928-1					24
1		980371-4					23
1		690472-2					22
1		1-18023-1					21
4		18025-2					20
1		690472-1					19
1		1338684-2					13
1		3-22280-3					12
1		356885-5					11
1		1-1320921-0					10
1		462006-6					9
1		2-1633621-1					8
1		240641-5					7
1							6
1		2-455889-0					5
1		238011-6					4
1		7-1633471-2					3
1		1-455888-1					2
1		2-1633664-8					1

DIMENSIONS:		TOLERANCES UNLESS OTHERWISE SPECIFIED:	
mm [IN]		9 PLC	±
		1 PLC	±
		3 PLC	±
		4 PLC	±
		ANGLES	±
MATERIAL		FINISH	

APPROVED	DATE	BY	CHK
M. HERR	21APR2010	M. HERR	M. HERR
M. HERR	09JUN2010	M. HERR	M. HERR
N. DEMING	09JUN2010	N. DEMING	N. DEMING

Ytyco Electronics	Ytyco Electronics
Harrisburg, PA 17105-3608	Harrisburg, PA 17105-3608
NAME	NAME
FINE ADJUST SIDE FEED HDI APPLICATOR	FINE ADJUST SIDE FEED HDI APPLICATOR
SIZE	SIZE
A 00779	A 00779
C=1530319	C=1530319
CUSTOMER ACCESSIBLE PRODUCTION DRAWING	CUSTOMER ACCESSIBLE PRODUCTION DRAWING
SCALE	SCALE
3:5	3:5
SHEET	SHEET
1 OF 1	1 OF 1
REV	REV
A	A