

Terminal (UNIT: mm)

250

(S)

Cable size (mm ²)	0.3 - 0.5
Cable overall diameter (mm)	1.4 - 2.4
Material	Brass
Surface treatment	Anti-Corrosion treatment
Reel (piece)	3000
Thickness (mm)	0.4 (Tab thickness : 0.8)

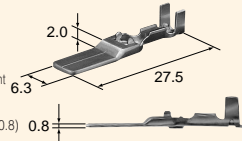

M(1400-7648) MM Terminal

Cable size (mm ²)	0.3 - 0.5
Cable overall diameter (mm)	1.4 - 2.4
Material	Brass
Surface treatment	Anti-Corrosion treatment
Reel (piece)	4000
Thickness (mm)	0.32

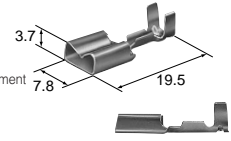

F(8245-4078) MF Terminal

250

(Heat-resistant S)

Cable size (mm ²)	0.3 - 0.5
Cable overall diameter (mm)	1.4 - 2.4
Material	Copper-steel alloy
Surface treatment	Tin-plated
Reel (piece)	2500
Thickness (mm)	0.4 (Tab thickness : 0.8)

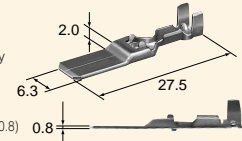

M(1400-9828) MM-H Terminal

Cable size (mm ²)	0.3 - 0.5
Cable overall diameter (mm)	1.4 - 2.4
Material	Copper-steel alloy/Copper-Nickel alloy
Surface treatment	Tin-plated only Copper-steel alloy
Reel (piece)	3500
Thickness (mm)	Copper-steel alloy 0.5/Copper-Nickel alloy 0.3

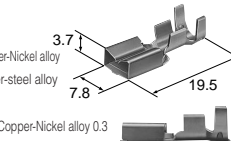

F(8245-4172) MF-H Terminal

250

(M)

Cable size (mm ²)	0.85 - 2
Cable overall diameter (mm)	1.8 - 3.4
Material	Brass
Surface treatment	Anti-Corrosion treatment
Reel (piece)	3000
Thickness (mm)	0.4 (Tab thickness : 0.8)

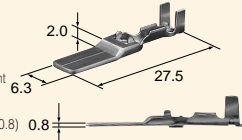

M(1401-7648) MM Terminal

Cable size (mm ²)	0.85 - 2
Cable overall diameter (mm)	1.8 - 3.4
Material	Brass
Surface treatment	Anti-Corrosion treatment
Reel (piece)	4000
Thickness (mm)	0.32

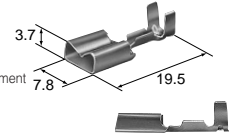

F(1401-7441) MF Terminal

250

(Heat-resistant M)

Cable size (mm ²)	0.85 - 2
Cable overall diameter (mm)	1.8 - 3.4
Material	Copper-steel alloy
Surface treatment	Tin-plated
Reel (piece)	2500
Thickness (mm)	0.4 (Tab thickness : 0.8)

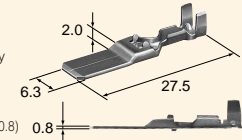

M(1401-9828) MM-H Terminal

Cable size (mm ²)	0.85 - 2
Cable overall diameter (mm)	1.8 - 3.4
Material	Copper-steel alloy/Copper-Nickel alloy
Surface treatment	Tin-plated only Copper-steel alloy
Reel (piece)	3500
Thickness (mm)	Copper-steel alloy 0.5/Copper-Nickel alloy 0.3

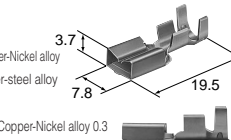

F(8245-4182) MF-H Terminal

250

(L)

Cable size (mm ²)	3
Cable overall diameter (mm)	3.6 - 4.1
Material	Brass
Surface treatment	Anti-Corrosion treatment
Reel (piece)	3000
Thickness (mm)	0.4 (Tab thickness : 0.8)

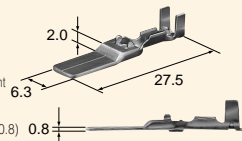

M(1402-7648) MM Terminal

Cable size (mm ²)	3
Cable overall diameter (mm)	3.6 - 4.1
Material	Brass
Surface treatment	Anti-Corrosion treatment
Reel (piece)	3000
Thickness (mm)	0.32

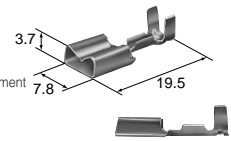

F(1402-7441) MF Terminal

250

(Heat-resistant L)

Cable size (mm ²)	3
Cable overall diameter (mm)	3.6 - 4.1
Material	Copper-steel alloy
Surface treatment	Tin-plated
Reel (piece)	2000
Thickness (mm)	0.4 (Tab thickness : 0.8)

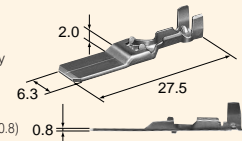

M(1402-9828) MM-H Terminal

Cable size (mm ²)	3
Cable overall diameter (mm)	3.6 - 4.1
Material	Copper-steel alloy/Copper-Nickel alloy
Surface treatment	Tin-plated only Copper-steel alloy
Reel (piece)	3500
Thickness (mm)	Copper-steel alloy 0.5/Copper-Nickel alloy 0.3

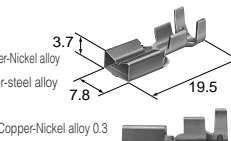

F(8245-4192) MF-H Terminal

58 SERIES

250/STANDARD M

● Explanation of products name sign.

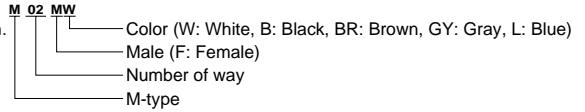

Housing (UNIT: mm)

Material/6Nylon

2way

Ref: Terminal part No.	Q-07
Housing color	White
Stopper color	Black

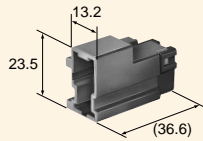

Stopper No. (6918-0073) **M(6101-1021)** M 02 MW

Ref: Terminal part No.	Q-07
Housing color	White
Stopper color	Black

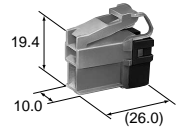

Stopper No. (6918-0073) **F(6101-5021)** M 02 FW

Ref: Terminal part No.	Q-07
Housing color	Gray
Stopper color	Black

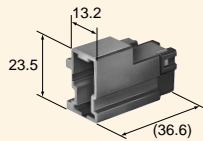

Stopper No. (6918-0073) **M(6101-1027)** M 02 MW-GY

Ref: Terminal part No.	Q-07
Housing color	Gray
Stopper color	Black

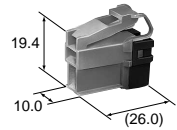

Stopper No. (6918-0073) **F(6101-5027)** M 02 FW-GY

Ref: Terminal part No.	Q-07
Housing color	Black
Stopper color	Gray

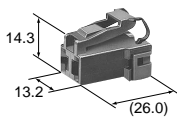

Stopper No. (6918-0078) **F(6101-5022)** M 02 FB

Q-08

3way

Ref: Terminal part No.	Q-07
Housing color	White
Stopper color	Black

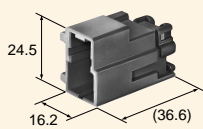

Stopper No. (6918-0074) **M(6101-1031)** M 03 MW

Ref: Terminal part No.	Q-07
Housing color	White
Stopper color	Black

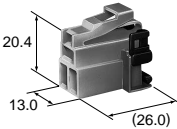

Stopper No. (6918-0074) **F(6101-5031)** M 03 FW

Ref: Terminal part No.	Q-07
Housing color	Gray
Stopper color	Black

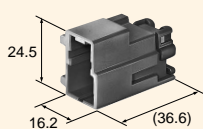

Stopper No. (6918-0074) **M(6101-1037)** M 03 MW-GY

Ref: Terminal part No.	Q-07
Housing color	Gray
Stopper color	Black

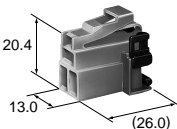

Stopper No. (6918-0074) **F(6101-5037)** M 03 FW-GY

Ref: Terminal part No.	Q-07
Housing color	Blue
Stopper color	Light Blue

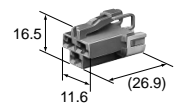

Stopper No. (6900-8335) **F(6101-5035)** M 03 FL

4way

Ref: Terminal part No.	Q-07
Housing color	White
Stopper color	Black

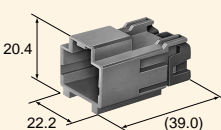

Stopper No. (6918-0075) **M(6101-1041)** M 04 MW

Ref: Terminal part No.	Q-07
Housing color	White
Stopper color	Black

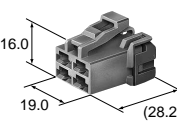

Stopper No. (6918-0075) **F(6101-5041)** M 04 FW

4way

Ref. Terminal part No. Q-07
Housing color Gray
Stopper color Black

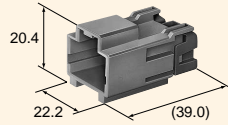

Stopper No. (6918-0075) **M(6101-1047)** M 04 MW-GY

Ref. Terminal part No. Q-07
Housing color Gray
Stopper color Black

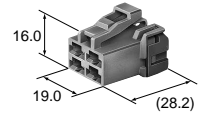

Stopper No. (6918-0075) **F(6101-5047)** M 04 FW-GY

6way

Ref. Terminal part No. Q-07
Housing color White
Stopper color Black

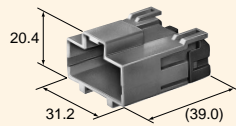

Stopper No. (6918-0076) **M(6101-1061)** M 06 MW

Ref. Terminal part No. Q-07
Housing color White
Stopper color Black

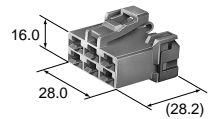

Stopper No. (6918-0076) **F(6101-5061)** M 06 FW

Ref. Terminal part No. Q-07
Housing color Gray
Stopper color Black

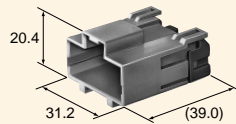

Stopper No. (6918-0076) **M(6101-1067)** M 06 MW-GY

Ref. Terminal part No. Q-07
Housing color Gray
Stopper color Black

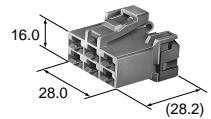

Stopper No. (6918-0076) **F(6101-5067)** M 06 FW-GY

Connector for Relay (UNIT: mm)

Material/6Nylon

3way

Ref. Terminal part No. Q-07
Housing color Gray
Stopper color Black

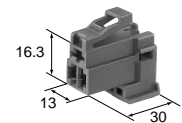

Stopper No. (6920-0073) **F(6098-0124)** M 03 FW-R

4way

Ref. Terminal part No. Q-07
Housing color Blue
Stopper color Light Blue

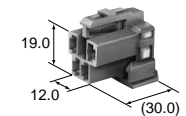

Stopper No. (6900-8657) **F(6420-8656)** M 04 FL-R

Ref. Terminal part No. Q-07
Housing color Green
Stopper color Light Blue

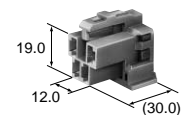

Stopper No. (6900-8657) **F(6421-8656)** M 04 FG-R

Q-09

58 SERIES

250/STANDARD M

6way

Ref: Terminal part No.	Q-07
Housing color	Gray
Stopper color	White

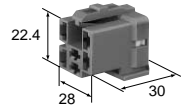

Stopper No. (6920-0074)

F(6098-0125)

M 06 FGY-R

Q-10